



HP

Digital Sender

8100C

Administrator  
Guide

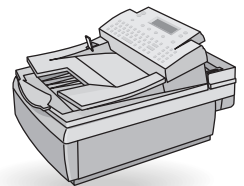





# HP Digital Sender 8100C

**Administrator Guide** \_\_\_\_\_

## Copyright information

© Copyright Hewlett-Packard Company  
2000

All rights reserved. Reproduction, adaptation, or translation without prior written permission is prohibited, except as allowed under copyright laws.

Publication number  
C7707-90006

First Edition, April 1, 2000

## Trademark credits

Adobe, the Adobe logo, Acrobat, the Acrobat logo, Adobe Circulate, and the Adobe Circulate logo are trademarks of Adobe Systems Incorporated.

CompuServe is a U.S. trademark of CompuServe, Inc. Microsoft, Windows and Windows NT are U.S. registered trademarks of Microsoft Corporation. Pentium is a U.S. registered product of Intel Corporation.

LDAP code (libldap client library and liblber encoding/decoding library) used courtesy of University of Michigan at Ann Arbor. Copyright 1992-1999 Regents of the University of Michigan. All rights reserved.

All other products mentioned herein may be trademarks of their respective companies

## Warranty

The information contained in this document is subject to change without notice.

Hewlett-Packard makes no warranty of any kind with respect to this information. HEWLETT-PACKARD SPECIFICALLY DISCLAIMS THE IMPLIED WARRANTY OF MERCHANTABILITY AND FITNESS FOR A PARTICULAR PURPOSE.

Hewlett-Packard shall not be liable for any direct, indirect, incidental, consequential, or other damage alleged in connection with the furnishing or use of this information.

NOTICE TO U.S. GOVERNMENT  
USERS: RESTRICTED RIGHTS  
COMMERCIAL COMPUTER SOFTWARE:  
"Use, duplication, or disclosure by the Government is subject to restrictions as set forth in subparagraph (c) (1) (ii) of the Rights in Technical Data Clause at DFARS 52.227-7013."

Material scanned by this product may be protected by governmental laws and other regulations, such as copyright laws. The customer is solely responsible for complying with all such laws and regulations.

## Safety information

### WARNING! Electrical shock hazard

To avoid electrical shock, use only supplied power cords and connect only to properly grounded (3-hole) wall outlets.

# Contents

## 1 About the digital sender

Introduction .....	5
Environments and protocols .....	6
Network operating systems .....	6
Dependency matrix .....	6
Features .....	7
Performance .....	7
Paper handling .....	7
Sending quality .....	8
Distribution services .....	9
Security .....	11
Components .....	12
Hardware components .....	12

## 2 Installing the digital sender

Installation process .....	15
The configuration process .....	16
E-Mail, I-Fax, and HP JetSend configuration .....	16
Extended and optional functionality .....	16
Assigning an IP address to the digital sender .....	17
Preparing for configuration .....	17
Configure e-mail parameters .....	20
Configure I-fax parameters .....	21
Configure extended and optional parameters .....	22
Test the installation .....	24
HP Web JetAdmin .....	24

## 3 Administering

Summary of administrator activities .....	25
Configuration menu parameters .....	26
Controlling security .....	31
Changing or setting administrator password .....	31
Erasing administrator password .....	31
Determining who can use the digital sender .....	32
Obtaining status and activity information .....	33
Job(s) state .....	33
Revision page .....	34
Tasks .....	36
Notification of e-mail delivery .....	37

Administrator tools.....	37
Shutting down and restarting .....	37
Resetting to factory defaults.....	38
Checking the address book database .....	39
Clearing the data base.....	40
B/W Contrast.....	41
Creating and maintaining user profiles.....	42
Working with address books .....	44
Maintaining the Public Lists address boo .....	45
Maintaining the Public E-mail address book .....	47
Maintaining user lists and addresses.....	48
Maintaining fax lists and numbers.....	48
Changing the contrast level of the LCD .....	48
Upgrading the digital sender firmware .....	49
Backing up and restoring the digital sende .....	50
Backing up the digital sende .....	50
Restoring the digital sender .....	51
Cleaning the digital sende .....	52
Digital Sender glass.....	52
ADF.....	53

## 4 Troubleshooting

Sources for information about problems .....	55
Troubleshooting the digital sende .....	56
General digital sender troubleshooting .....	56
Control panel messages .....	56
Troubleshooting network problems.....	62
Network interface card troubleshooting .....	62

## 5 Warranty and support information

Hewlett-Packard limited warranty statement .....	63
Hewlett-Packard Year 2000 warranty.....	65
Replacement parts and accessories.....	66
HP customer support options worldwide.....	67
HP support.....	69

## Appendix A Specifications

Equipment specifications.....	71
Environmental range .....	73
Supported capabilities .....	74
Declarations of Conformity.....	75
German noise declaration .....	77

## Index

# 1 About the digital sender

## Introduction

The HP Digital Sender 8100C can be directly connected to TCP/IP networks. It converts black-and-white and color documents, drawings, and photographs into electronic format and distributes them directly to several types of destinations

- e-mail addresses
- fax numbers
- HP JetSend-enabled printers

The unit includes a flatbed scanner and an automatic document feeder (ADF) that can accept up to 25 pages.

Registered users can create their own address books of e-mail addresses and combine e-mail addresses into personal distribution lists. Users can also add fax numbers to public phone books. The destinations and distribution lists can then be selected at the digital sender control panel.

The administrator has the ability to create public e-mail destinations and distribution lists and make them available to all users.

The HP Digital Sender 8100C supports LDAP (Lightweight Directory Access Protocol), which allows you to find and use e-mail addresses located on directory servers located elsewhere on a network (such as the Internet) over a TCP/IP connection. See the HP digital sender website for a list of global e-mail address books:

<http://www.digitalsender.hp.com>

Installing the digital sender is simply a matter of making a few connections and configuring a few network and e-mail parameters. The digital sender operates as a stand-alone unit and does not require network privileges to administer.

The HP JetDirect print server (network interface card) that comes installed in the digital sender handles all protocol support for TCP/IP and SMTP automatically.

## Environments and protocols

### Network operating systems

The HP Digital Sender 8100C must be directly connected to a TCP/IP network. A 10Base-T ethernet connection is provided by the network interface card that comes installed in the digital sender.

### Dependency matrix

The following table shows the HP Digital Sender 8100C services that are available and their dependencies.

#### Dependency matrix

Service	Dependencies
Send to e-mail	An e-mail SMTP-MIME server directly connected to a TCP/IP network that can be reached from the digital sender (not a dial-up connection).
Send to Internet fax	An e-mail SMTP-MIME server directly connected to a TCP/IP network that can be reached from the digital sender (not a dial-up connection), and an account with an Internet fax provider.
Send to an HP JetSend-enabled printer	A HP JetSend-enabled printer connected to the network.



# Features

## Performance

For maximum scanning speeds, see [“Equipment specifications” on page e71](#).

## Paper handling

The HP Digital Sender 8100C supports multiple paper sizes:

- Letter: 215.9 by 279 mm (8.5 by 11 inches)
- A4: 210 by 297 mm (8.3 by 11.7 inches)
- Legal (from the ADF only): 215.9 by 355.6 mm (8.5 by 14 inches)

Paper weight: 60 to 105 g/m<sup>2</sup> (16 to 28 lb . )

Up to 25 sheets of letter, A4, or legal paper can be stacked in the ADF (maximum height of 3 mm, or 0.1 inches).

### ADF paper sizes

Item	Width	Length
Maximum paper size	215.9 mm (8.5 inches)	355.6 mm (14 inches)
Minimum paper size	148.5 mm (5.9 inches)	210 mm (8.3 inches)

## Sending quality

The digital sender offers a choice of sending qualities at the control panel. You can choose the most suitable quality for each type of job.

### Sending qualities and destinations

<b>Sending quality</b>	<b>Type of document</b>	<b>Destinations</b>
B/W Document	The original contains text that must be clearly transmitted. -Or- The original is black and white.	E-mail Fax HP JetSend printer
Color Document	The original has a mix of text and images. -Or- The original has a mix of color and black-and-white areas.	E-mail HP JetSend printer
Color-B/W Phot	The original is a photograph. -Or- The colors or shades of gray in an image must be transmitted clearly.	E-mail HP JetSend printer

## Distribution services

The digital sender is capable of distributing documents to the following types of destinations:

- e-mail addresses
- fax phone numbers (via fax Internet service)
- HP JetSend-enabled printers

## E-mail destinations

The digital sender can send MIME-compliant e-mail messages to Internet addresses. It uses SMTP-MIME to deliver these messages. SMTP is independent of the network operating system on which your e-mail server is running. The e-mail service is also compatible with the DSN (Delivery Status Notification) standard.

ESMTP (Extended SMTP) is used if your server supports it. This capability is automatically detected and configurable.

The document scanned at the digital sender becomes an attachment to your e-mail message. Portable Document Format (.pdf) is the file format most often used for the attachments, which gives recipients the ability to both view and print them. You can obtain a free copy of the Adobe® Acrobat® Reader from the Adobe Systems Incorporated website (<http://www.adobe.com>).

Documents can also be scanned as TIFF (.tif), a graphics format importable into most imaging and word processing programs. Text scanned in B/W Document sending quality can also be read by OCR programs.

Users can specify e-mail destinations at the control panel in several ways:

- Select e-mail addresses from public or personal address books already loaded in the digital sender.
- Use a special search feature to select e-mail addresses from an LDAP (Lightweight Directory Access Protocol) server, if one has been configured for use by the administrator
- Type e-mail addresses manually.

## Internet fax destinations

Users can send faxes directly from the digital sender. They have the ability to select destinations from a fax numbers book already loaded in the digital sender, or type the at the control panel. The same document can be sent to multiple fax numbers.

Sending faxes with the digital sender requires an account with a supported Internet fax provider. Visit the HP digital sender website (<http://www.digitalsender.hp.com>) for a list of the Internet fax providers that are currently supported.

## HP JetSend-enabled printer destinations

You can enable send to printer by setting up one or more HP JetSend-enabled printers on the network for use with the digital sender. The printers you designate must be HP JetSend-enabled, connected to the network, and have a valid TCP/IP address. See the HP JetSend website (<http://www.jetsend.com>) for a list of HP JetSend-enabled printers.

## Security

The HP Digital Sender 8100C operates as a stand-alone unit on the network. You administer each digital sender independently of any other device on the network under a password that applies only to that digital sender.

The digital sender accepts three types of users:

- **registered users**

Individuals who have created their own user profile on the digital sender. Only registered users have personal e-mail address books and lists that are accessible at the digital sender.

- **guest users**

Individuals who are not registered users and who do not have user profiles. Guest users can use the digital sender and all public address books. However, they cannot see or use personal address books. The administrator can disable guest user access.

- **administrator for the digital sender**

The individual (referred to as the “administrator” in this guide) who performs administrator activities for the digital sender. Because the digital sender is a stand-alone unit on the network, these activities can be performed independently of any other network activity. Network administrator privileges for the digital sender do not require network privileges. Activities include such things as establishing the level of security for the digital sender and maintaining the public address books. The administrator has access to all personal address books.

The administrator controls digital sender security in these ways:

- Determining who can use the digital sender (registered users and guest users, or only registered users).
- Requiring passwords. Passwords are available at two levels: administrator and registered users. Both are optional. Passwords control what each type of user can see and do at the digital sender.
- Enabling or disabling self-registration for users. If disabled, only the administrator can add or modify user profiles.

# Components

## Hardware components

The following illustrations show the digital sender hardware components.

### Front and top view

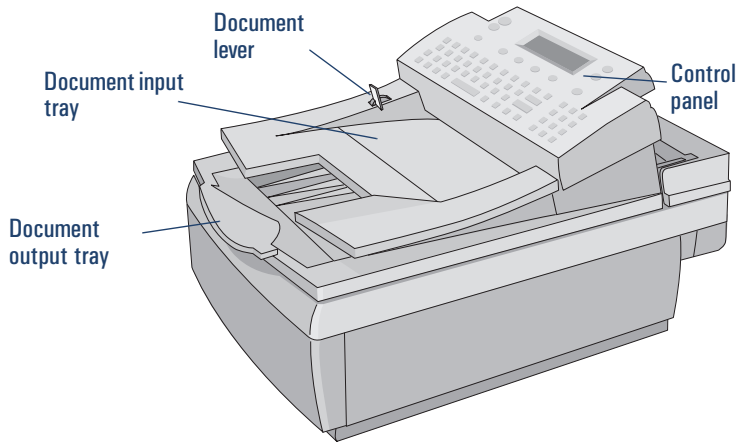

### Front view with ADF unit raised

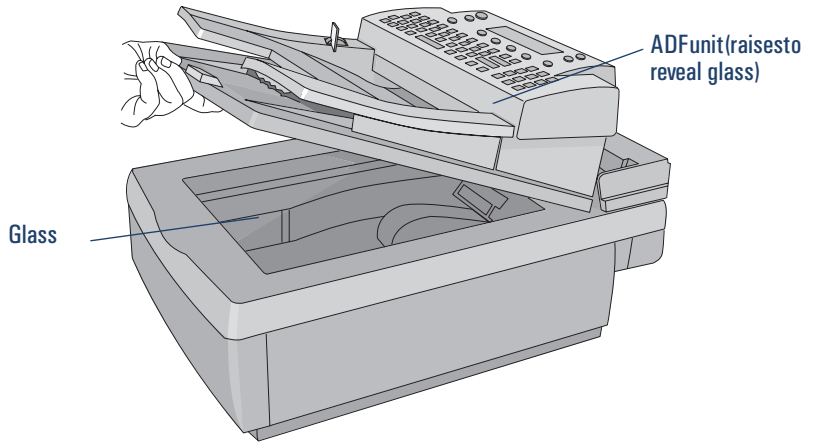

### Rear view

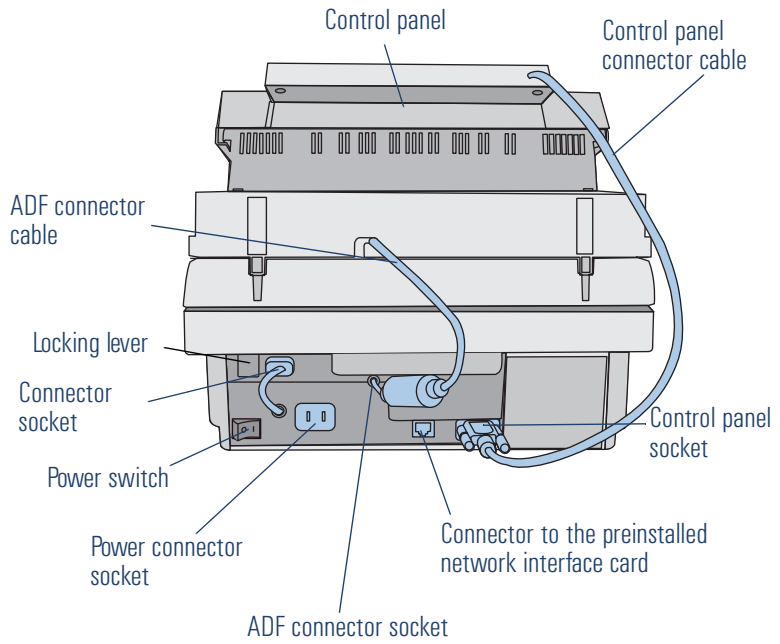



# 2 Installing the digital sender

## Installation process

See the Welcome Poster for installation and initial setup of the H P Digital Sender 8100C. This Administrator's Guide provides much more detail on configuring the digital sender.

## The configuration process

### E-Mail, I-Fax, and HP JetSend configuration

After you have physically installed the digital sender, you only need to configure a few parameters to begin using it. After you have configured these parameters, you will be able to:

- send e-mail messages
- use e-mail addresses located on an LDAP server of your choosing
- send faxes (requires information provided by i-fax vendor)
- send documents to HPJetSend-enabled printers on your network
- discover the digital sender over the network with HP Web JetAdmin

### Extended and optional functionality

Once you have established the digital sender on the network and enabled basic functionality, you can extend functionality for the services you wish to implement. You can also configure optional parameters for the services you have already set up.

In general, the extended and optional features consist of the following:

- security preferences
- DNS and WINS name resolution

## Assigning an IP address to the digital sender

The easiest method for assigning an IP address to the digital sender is by entering it directly at the control panel. You can also assign an IP address using a DHCP or BOOTP server. You might be more familiar with assigning IP addresses to network devices from a DHCP or BOOTP server. In this scenario, you prepare the device attached to the network, make an entry for it on the DHCP or BOOTP server, and then turn the device on. The HP JetDirect print server (network interface card) inside the HP Digital Sender 8100C picks up its IP information from the DHCP or BOOTP server.

---

**Note**

You can let the digital sender time out to a default IP address. In fact, this happens automatically if you do not manually assign an IP address at the control panel within the timeout period of 2 minutes.

The default IP address is not a valid address. You must change the address to one of your own assignment. You can use the control panel to do this at any time.

---

## Preparing for configuration

Before you start configuring the HP Digital Sender 8100C for the first time, take a few minutes to prepare so that you can complete the steps without interruption. Use the checklist on the following page.

## Configuration Checklist

### Decisions needed for installation

- Register the digital sender.
- Method you want to use to assign IP address to the digital sender: manually at the control panel, or from a DHCP or BOOTP server.

### Information needed for e-mail configuration

- IP address for the digital sender \_\_\_\_\_
- IP subnet mask \_\_\_\_\_
- IP gateway \_\_\_\_\_
- E-mail server address \_\_\_\_\_
- E-mail default from (e-mail address) \_\_\_\_\_
- If you choose to enable the LDAP directory service (optional)
  - LDAP server address \_\_\_\_\_
  - LDAP search root \_\_\_\_\_

### Additional information needed for I-Fax configuration

- Fax provider domain  
(supplied by Internet fax provider) \_\_\_\_\_
- Fax billing address (e-mail address) \_\_\_\_\_
- Prefix or Postage to use before fax number  
(supplied by Internet fax provider) \_\_\_\_\_
- File format (PDF or TIFF--determined by Internet fax provider) \_\_\_\_\_

### Additional information needed for HP JetSend configuration

- HP JetSend-enabled printer addresses \_\_\_\_\_  
\_\_\_\_\_

### Decisions and information needed for extended functionality

- Do you want to enable DNS or WINS name resolution?
  - IP address of the DNS server \_\_\_\_\_
  - IP address of the DNS server domain \_\_\_\_\_
  - IP address of the WINS server \_\_\_\_\_
- Do you want to set up registered users at this time?
  - For each user you will need: user name and user e-mail address.
- Do you want to enable guest usage?
- Do you want to allow user self-registration?

## To configure parameters

- 1 If you have not already done so, turn the digital sender on.
- 2 Press **SETUP (ALT + F4)** from the main menu to go to the setup menu.
- 3 Press **SETTINGS (F2)** and use the arrow keys to highlight the **General** configuration menu from the list which appears. Press **OK (F1)**.
- 4 In the configuration menu, use the arrow keys to scroll to a parameter you want to modify and then press **CHANGE (F3)**.
- 5 Configure the parameters by selecting a value from a list using the arrow keys or by typing in a value.
- 6 When finished, press **OK (F1)**. Choose another parameter from the menu.
- 7 When finished with the **General** configuration menu, press **SAVE (F1)**.
- 8 Repeat steps 3 through 7 for the **Network, E-Mail, I-Fax,** and **Advanced** configuration menus.

## Configure e-mail parameters

After you have physically installed the digital sender, you only need to configure a few parameters to begin using the digital sender. After you have configured these parameters, you will be able to send e-mail messages and use e-mail addresses located on an LDAP server of your choosing. The e-mail parameters consist of the following (see [“Configuration menu parameters” on pag e26](#) for more detailed explanations):

### General Configuration Menu

- **Administrator E-mail** (e-mail address of the administrator used to register the digital sender)
- **Administrator Password** (to restrict access to configurable parameters.)

### Network Configuration Menu

- **IP configuration** (to specify how the digital sender receives its TCP/IP configuration—manually or from a DHCP or BOOTP server)
- **IP Address** (of the digital sender)
- **IP Subnet Mask**
- **IP Gatewa** (IP address of the gateway server used to send packets from the local network)

### E-Mail Configuration Menu

- **E-mail Server Add** . (IP address of the SMTP-MIME e-mail server)
- **E-mail Default From** (default e-mail address for the FROM field of e-mail messages from the digital sender)
- **LDAP Server Address** (IP address of the server that hosts the LDAP server—not required)
- **LDAP Search Root** (basepoint from which to start searches for names on the LDAP server—may be required if you configure an LDAP server address)

## Configure I-fax parameters

After you have configured the digital sender to send e-mail, you only need to configure a few additional parameters to begin sending faxes. Information for the i-fax parameters are issued by your Internet fax provider. (See [“Configuration menu parameters” on page e26](#) for more detailed explanations):

### I-Fax Configuration Menu

- **Fax Provider Domain** (an Internet address)
- **Fax # Prefix** (not required by all Internet fax providers)
- **Fax Postage** (not required by all Internet fax providers)
- **Fax Account E-mail** (to receive billing information from the Internet fax provider)
- **Fax File Format** (determined by the provider)

## Configure extended and optional parameters

Listed below are some additional parameters you can configure for extended and optional functionality (see [“Configuration menu parameters”](#) on page 26 for detailed explanations of all parameters )

### General configuration menu

- **Admin Full Name** (full name of the administrator)
- **Language** (for the control panel, if other than English)
- **Date, Time, Time Zone** (of the digital sender)
- **Paper Size** (default size for the scanning area)
- **Allow GuestLogin** (either on or off)
- **Address Caching Enabled** (either on or off)
- **User Self-Registration Enabled** (either on or off)

### E-Mail configuration menu

- **E-mail Default Subject** (default text for the **SUBJECT** field in e-mail messages sent by the digital sender)
- **LDAP Service Port, LDAP Account Name, LDAP Password** (additional parameters for configuring the LDAP directory service)

### Network configuration menu

- **DNS Server Address , DNS Domain** (for DNS name resolution)
- **WINS Server Address** (for WINS name resolution)



## To add HP JetSend-enabled devices

As a convenience for your users, you can add the addresses of HP JetSend-enabled printers used in your office. Users can then select from a list of HP JetSend-enabled printers rather than manually entering an IP address or DNS name.

To add a HP JetSend-enabled printer to the list:

- 1 At the control panel, press **PRINT (F3)**.
- 2 Type the IP address or DNS name for the HP JetSend-enabled printer you want to add, and then press **◆**. The printer is added to the list.

---

### Note

---

In order to use DNS names instead of IP addresses, first configure the DNS Server Address and DNS Domain settings in the **Network** configuration menu.

- 3 If you want to add another HP JetSend-enabled printer, press **NEW (F1)** and repeat step 2. The list can contain up to 64 devices.

## Test the installation

Use the following steps to verify the digital sender setup.

### To test the installation

- 1 Display the Revision page to verify that the network interface card is successfully linked to the network. The TCP/IP status parameter should read **FEED**. To display the page, select **STATUS (ALT + F3)**, then **REVISION (F1)**. Press **BACK (F4)** to close.
- 2 Test the e-mail service to confirm that the digital sender can communicate through Internet e-mail. See the user guide for instructions on sending e-mail. Be sure to type your address in the To field.
- 3 Test the Internet fax service by sending a test fax to a local fax number. See the user guide for instructions on sending faxes.
- 4 Test the print function by sending a document to a HP JetSend-enabled printer. See the user guide for instructions on sending to a printer.

## HP Web JetAdmin

HP Web JetAdmin is an optional utility for use with the digital sender. It is a browser-based program that lets you remotely configure, monitor, and control HP network peripherals such as printers, plotters, scanners, and digital senders. Download the HP Web JetAdmin software from the HP digital sender website ([www.hp.com/go/webjetadmin/](http://www.hp.com/go/webjetadmin/)).

# 3 Administering

## Summary of administrator activities

Procedures in this chapter explain how to perform administrator activities at the control panel.

Access to administrator-specific activities is blocked by the administrator password. It is recommended that administrator create a password during the setup of the HP Digital Sender 8100C.

## Configuration menu parameters

Parameters that use an IP address can show only the numeric address, even when a symbolic name has been assigned to a device.

### Configuration parameters on the control panel

Parameter	Description
<b>General Menu</b>	
Administrator E-mail	Administrator e-mail address (required). Up to 255 characters are allowed.
Administrator Full Name	Full name of the administrator. Up to 31 characters are allowed.
Administrator Password	Password for this digital sender. You can have a different password for each digital sender. Up to 15 characters are allowed. The password is case-sensitive.
Language	Language in which keys and messages appear at the control panel. Choices: English, French, German, Italian, or Spanish. The language changes as soon as you select a different language.
Date	Current date. <b>CLEAR</b> sets the date to Jan 1, 1980.
Time	Current time (24-hour clock). <b>CLEAR</b> sets the time to midnight (0:0).
Time Zone	Based on Greenwich Mean Time (GMT). In the USA, Eastern Standard Time is five hours (-5:00) behind GMT.
Paper Size	Default size for the scanning area. Users can override this setting at the control panel. Choices: Letter, A4, or Legal.
Allow Guest Logi	Permission for non-registered users to send e-mail and send i-fax.
Address caching enabled	E-mail addresses and fax numbers entered during sending of a transmission are automatically added to the user's personal address book. If disabled, users must manually add an address or phone number to their personal lists.

## Configuration parameters on the control panel (continued)

Parameter	Description
User self-registration enabled	Permission for users to create their own user profile. If disabled, only the administrator can add or change user profiles.
<b>Network Menu</b>	
IP Configuration	<p>To specify how the digital sender network interface card obtains its TCP/IP configuration. Choices:</p> <ul style="list-style-type: none"> <li>● <b>MANUAL.</b> From the control panel.</li> <li>● <b>BOOTP (Boot Protocol) or DHCP (Dynamic Host Configuration Protocol).</b> Automatically from the network (the IP Address, IP Subnet Mask, and IP Gateway parameters are ignored). A corresponding server must be running and properly configured. The next time you open the configuration menu, you see the values that the network interface card automatically discovered. See <a href="#">“Assigning an IP address to the digital sender” on page 17</a> for details.</li> </ul> <p>Two things happen if you configured the IP address using BOOTP or DHCP and later change the IP address at the control panel: (1) the IP address that was assigned is released and (2) the setting for this parameter changes to <b>MANUAL</b>. Changing this value causes the digital sender to shut down and restart.</p>
IP Address	<p>Unique TCP/IP network address of the HPJetDirect print server (network interface card) in the digital sender. Required for the digital sender to work.</p> <p><b>CLEAR</b> sets the address to 0.0.0.0.</p> <p>Changing this value causes the digital sender to shut down and restart.</p>
IP Subnet Mask	<p>The filter used to identify the subnet of the network interface card in the digital sender.</p> <p><b>CLEAR</b> sets the address to 0.0.0.0.</p> <p>Changing this value causes the digital sender to shut down and restart.</p>
IP Gateway	<p>IP address of the gateway server used to send packets off the local network.</p> <p><b>CLEAR</b> sets the address to 0.0.0.0.</p> <p>Changing this value causes the digital sender to shut down and restart.</p>

### Configuration parameters on the control panel (continued)

Parameter	Description
DNS Server Address	<p>IP address of the DNS server. Used for DNS (Domain Name System) symbolic name resolution if you identify servers and devices on your network by network name instead of by IP address.</p> <p><b>CLEAR</b> sets the address to 0.0.0.0.</p> <p>If left blank or set to 0.0.0.0, the function is disabled.</p>
DNS Domain	<p>If DNS name resolution is used, the IP address of the domain for the DNS server. Up to 256 characters are allowed.</p> <p>If left blank, the function is disabled.</p>
WINS Server Address	<p>IP address of the WINS server. Used for WINS (Windows Internet Naming Service) symbolic name resolution if you identify servers and devices on your network by network name instead of by IP address.</p> <p><b>CLEAR</b> sets the address to 0.0.0.0.</p> <p>If left blank or set to 0.0.0.0, the function is disabled.</p>
<b>E-mail Menu</b>	
E-mail Server Addr.	<p>IP address of the e-mail SMTP-MIME server.</p> <p><b>CLEAR</b> sets the address to 0.0.0.0.</p> <p>If left blank or cleared, the e-mail service is disabled. Both the E-mail Server Addr. and E-mail Default From parameters must be enabled for the e-mail service to work.</p>
E-mail Default Fro	<p>Default e-mail address for the <b>FROM</b> field in e-mail messages from the digital sender. This default address is used <i>only</i> when users have not registered at the control panel and send an e-mail message without entering anything in the <b>FROM</b> field. Up to 255 characters are allowed.</p> <p>If left blank or cleared, the e-mail service is disabled. Both the E-mail Server Addr. and E-mail Default From parameters must be enabled for the e-mail service to work.</p> <p>Note: You must provide a default e-mail address to prevent users from sending anonymous e-mail messages.</p>
E-mail Default Subje c	<p>Default text for the <b>SUBJECT</b> field in e-mail messages sent by the digital sender.</p> <p>This default text is used <i>only</i> when users do not provide a subject of their own directly from the control panel keypad. Up to 128 characters are allowed.</p>

**Configuration parameters on the control panel (continued)**

<b>Parameter</b>	<b>Description</b>
E-mail Qualit	Default image quality used for documents sent by e-mail. Choices: B/W Document, Color Document, Color-B/W Photo.
E-mail File Form a	Default format for documents sent by e-mail. Choices: PDF or TIFF
Auto BCC Function Enable	Registered user who activates the copy self option in the user profile receives a copy of any e-mail message the user sends from the digital sender.
LDAP Server Address	IP address of the server that hosts the LDAP (Lightweight Directory Access Protocol) directory for e-mail address searches. <b>CLEAR</b> sets the address to 0.0.0.0. If left blank or cleared, the function is disabled.
LDAP Search Root	Basepoint (root) from which to start searches for names on the LDAP directory server. Directories are often represented in a hierarchical way using a tree. The basepoint might be a country, an organization, or other type of group. Not all servers require this information. Up to 512 characters are allowed. See the digital sender website for examples ( <a href="http://www.digitalsender.hp.com">http://www.digitalsender.hp.com</a> ).
LDAP Service Port	TCP/IP port number on which the LDAP directory server is listening. The default port is 389.
LDAP Account Name	Account name used when the LDAP server requires an authenticated login. Up to 512 characters are allowed.
LDAP Password	Password associated with the LDAP Account Name.
<b>I-fax menu</b>	
Fax Provider Domain	Internet address for the Internet fax account. Issued by the Internet fax provider.
Fax # Prefix	Number placed before the fax number
Fax Postage	Security feature required by some Internet fax providers.
Fax Account E-mail	E-mail address associated with the Internet fax account. Used by the fax provider for billing purposes.
Fax File Format	Format for documents sent by Internet fax. Choices: PDF or TIFF

**Configuration parameters on the control panel (continued)**

<b>Parameter</b>	<b>Description</b>
<b>Advanced Menu</b>	
E-mail File Selection	Permission for users and guests to select PDF or TIFF format for their messages.
Max User Mail Size	Restriction on e-mail message sizes allowed to be sent by users and guests. Can be set to No Limit.
E-mail Language	Language used in the e-mail cover message. Choices: English, French, German, Italian, Spanish.
Mail Ping Frequency	Interval (in minutes) at which the digital sender verifies its connection to the e-mail server. If the connection is lost, an error message appears.
ESMTP Function Enable	Extended e-mail functions.



# Controlling security

## Changing or setting administrator password

Unless a password is used, anyone can perform sensitive administrator activities. Therefore, the administrator is encouraged to create a password during the setup of the HP Digital Sender 8100C.

---

**Note**

The administrator password is case-sensitive.

### To change or set administrator password

- 1 Make sure the digital sender is idle.
- 2 At the control panel, press **SETUP (ALT + F4)**. Then press **SETTINGS (F2)**.
- 3 Select the **General** configuration menu. If an administrator password is already required, the **HP Digital Sender 8100C Administrator's Password** dialog box appears. Type the password and press **OK (F1)**.
- 4 When the configuration menu appears, select **Administrator Password** and then press **CHANGE (F3)**.
- 5 Type the old administrator password and press **ENTER**.
- 6 Type the new password and press **ENTER**.
- 7 Type the new password again and press **CONFIRM (F1)**.
- 8 Press **SAVE (F1)** to save the password and exit the menu.

### Erasing administrator password

If you forget the administrator password, and cannot access any of the password-protected areas, call HP Technical Support ([see pag e66](#)).

## Determining who can use the digital sender

The administrator determines who can use the digital sender: either registered users (only those with a user profile) or both registered users and guest users.

### To determine who can use the digital sender

- 1 Make sure the digital sender is idle.
- 2 At the control panel, press **SETUP (ALT + F4)**. Then press **SETTINGS (F2)**.
- 3 Select the **General** configuration menu. If an administrator password is required, the **HP Digital Sender 8100C Administrator's Password** dialog box appears. Type the password and press **OK (F1)**.
- 4 Use the **Allow guest login** field to indicate your preference. On accepts guest login, Off prohibits guests from using the digital sender.
- 5 Use the **User self-registration enabled** field to indicate your preference. On allows users to register themselves, Off allows only the administrator to register users.
- 6 Press **SAVE (F1)**.

---

**Note**

---

For more information on registered users, see [“Creating and maintaining user profiles” on page 42](#).

## Obtaining status and activity information

Use these tools to learn the status of the digital sender and its jobs:

- job(s) state
- Revision page
- Tasks page

### Job(s) state

The job state screen shows the status of the last five jobs processed by the digital sender, with the latest job listed first. To view the Job(s) state screen press **STATUS** (**ALT + F3**). Each job has the following information associated with it:

- time processed
- type of job (e-mail, fax, or print)
- user (name of user profile which sent the job)
- status (see below)

### Job status

Status	Description
Processing	Pages still being scanned by the digital sender.
Sending	The digital sender is attempting to locate the job's destination.
Sent	The job has successfully been delivered to its destination.
NW Error	Network error. The job has failed to be delivered. This message will appear if the destination HPJetSend-enabled printer is busy or out of paper, or the sending process times out.
PP Error	Post processing error. An error occurred when the digital sender was converting the page(s) to PDF or TIFF. Try re-scanning and re-sending the message.

## Revision page

The Revision page displays useful information about the digital sender (see the table on the next page). Use it for the following reasons:

- verify configuration settings
- verify the operating status of the network interface card
- learn the MAC address of the digital sender
- learn firmware version numbers

The Revision page is in English only (even if you configure the control panel for a different language).

### To display the Revision page

- 1 At the control panel, press **STATUS (ALT + F3)**.
- 2 Press **REVISION (F1)**.

## Revision page parameters

Parameter	Descriptions
Box Version	Product version
FW Ver.	Version of firmware installed in the digital sender.
FW Date	Release date of the firmware installed in the digital sender.
HP JetDirect Prd. #	Product number of the network interface card: <ul style="list-style-type: none"> <li>● HPJ3113A Ethernet (10Base-T) networks</li> </ul>
HP JetDirect FW Rev	Version of firmware installed on the network interface card (G.xx.xx).
MAC Address	Unique LAN hardware address assigned to the network interface card at the time of manufacture (for example, 0060B072525E).
IP Address	Unique TCP/IP address of the network interface card. This is assigned by the administrator
Subnet Mas	If subnets are used, the filter used to identify the subnet of the HPJetDirect print server (network interface card). This is assigned by the administrator.
TCP/IP statu	Status of the connection to the network: <ul style="list-style-type: none"> <li>● INITIALIZING The network interface card is searching for a valid IP address. After 2 minutes, a default IP address is automatically assigned.</li> <li>● READY The network interface card has been assigned an IP address and is actively connected to the network.</li> <li>● ERROR A network or network interface card error has been detected.</li> </ul>
Gateway Addr.	IP address of the default gateway server used to communicate with nodes on other subnets or networks.
Received pkts	Total number of packets received without error.
Bad packets	Total number of packets received with errors.
Framing err .	Total number of packets received that contained a CRC (cyclic redundancy check) or framing (alignment) error.
Transm. pkts	Total number of packets transmitted without error on the network.
Collisio n	Total number of packets that were not transmitted due to successive collisions.
Late collision	Total number of packets that were not transmitted due to late collisions (collisions after the 64th byte of a packet).

## Revision page parameters (continued)

Parameter	Descriptions
Log Server Addr.	IP address of the host computer that receives syslog messages from the HP JetDirect print server.
HP JetDirect Cfg.	Indicates how the digital sender has received its TCP/IP configuration: <ul style="list-style-type: none"> <li>● DHCP Automatically from a DHCP server</li> <li>● MANUAL Manually from entries made at the control panel.</li> </ul>
HP JetDirect Timeout	Timeout value in seconds that an idle data connection is allowed to remain open. Valid values are 0 to 3600. A value of 0 disables the timeout mechanism. The default is 90 seconds.
HP JetDirect ID	HP manufacturing identification code assigned to the network interface card.
Boot BlockVer .	Version of the digital sender startup (boot) program. This information is used only by HP manufacturing and HP customer support.
Multi-BootVer .	Version of the digital sender multi-boot program. This information is used only by HP manufacturing and HP customer support.
Engine FW Ver.	Version of firmware used by the digital sender scanner engine. This information is used only by HP manufacturing and HP customer support.
Running Image	The firmware image currently running. Either 1 or 2.

## Tasks

The **Tasks** page lists the services running on the digital sender at that moment. Each task is assigned a Status, Error Number (Errno), and State (St). Tasks cannot be modified or deleted and are diagnostic tools that may be referred to by HP Technical Support staff.

### To display the **Tasks** page

- 1 At the control panel, press **STATUS (ALT + F3)**.
- 2 Press **TASKS (F2)**.

## Notification of e-mail delivery

A user can choose whether or not to receive a receipt for the delivery of an e-mail. If the user chooses to receive a receipt, the user receives a notification of e-mail delivery. If the administrator enables AutoBCC in the **E-mail** configuration menu, the user will receive a return copy of the message.

Notes about notifications:

- E-mail notifications require that the recipients have an e-mail address configured in their user profile.

## Administrator tools

Items in the **Tools** menu are generally used for troubleshooting or diagnostic reasons. This identical menu is found in each of the configuration menus. If no administrator password has been configured, any user has access to the **Tools** menu. Therefore, it is recommended that an administrator password be created when the digital sender is set up.

## Shutting down and restarting

Use the shutdown procedure for the following reasons:

- to prepare the digital sender to be physically turned off (for example, when you need to replace a part or to close down for holidays)
- when instructed to do so by troubleshooting steps or HP customer support

Notes about the procedure:

- Shutdown locks the digital sender from use until you restart it. The procedure does not turn the power off.
- Jobs in process might be interrupted and lost.

## To shut down

- 1 Make sure the digital sender is idle.
- 2 At the control panel, press **SETUP (ALT + F4)**. Then press **SETTINGS (F2)**.
- 3 Select any of the configuration menus. If an administrator password is required, the **HP Digital Sender 8100C Administrator's Password** dialog box appears. Type the password and press **OK (F1)**.
- 4 When the configuration menu appears, press **TOOLS (F2)**.
- 5 Select **Shutdown** and press **OK (F1)**.

---

### Note

A shutdown key sequence exists that will shut down the digital sender if it becomes unresponsive and therefore will not navigate to the **Shutdown** option. The code is: **SHIFT + ALT + /**.

---

## Resetting to factory defaults

Use this procedure for the following reasons:

- when you want to completely reconfigure the digital sender and all address books
- when instructed to do so by troubleshooting steps or HPcustomer support

Resetting the digital sender to factory defaults is a combination of resetting address books and resetting network parameters. It does the following:

- erases the administrator password
- locks the digital sender from use until the reset is complete
- erases the configuration for TCP/IP, DNS/WINS, security, e-mail, fax, and LDAP settings
- erases the contents of all public and personal address books, distribution lists, and phone books.

Notes about the procedure:

- After you reset the digital sender to the factory defaults, neither you nor any users can use the digital sender again until you have reconfigured it, starting with the steps under ["Configure e-mail parameters" on pag e20](#).

---

### CAUTION

This action cannot be undone.



## To reset to factory defaults

- 1 Make sure the digital sender is idle.
- 2 At the control panel, press **SETUP (ALT + F4)**. Then press **SETTINGS (F2)**.
- 3 Select any of the configuration menus. If an administrator password is required, the **HP Digital Sender 8100C Administrator's Password** dialog box appears. Type the password and press **OK (F1)**.
- 4 When the configuration menu appears, press **TOOLS (F2)**.
- 5 Select **Factory defaults** and press **OK (F1)**.
- 6 Press **OK (F1)** to confirm that you want to reset to factory defaults.

## Checking the address book database

At any time, you can check the database of address books to correct problems and inconsistencies in the information.

Perform the database check for the following reasons:

- when the digital sender seems to be performing slowly for no apparent reason
- when the digital sender was inadvertently turned off during a sensitive operation (such as saving configuration changes)
- when you detect inconsistencies between address books and distribution lists
- when instructed to do so by troubleshooting steps or by HPcustomer support

Notes about the procedure:

- The procedure causes the digital sender to shut down and then restart.
- The procedure can take as long as 25 minutes, based on the amount of information in address books.

---

### Note

If the check fails, turn the digital sender off and back on, and then try again. If the problem persists, the address book database is beyond recovery. Clear the address book database ([see pag e40](#)).

---

## To check address books

- 1 Make sure the digital sender is idle.
- 2 At the control panel, press **SETUP (ALT + F4)**.
- 3 Select any configuration menu. If an administrator password is required, the **HP Digital Sender 8100C Administrator's Password** dialog box appears. Type the password and press **OK (F1)**.
- 4 When the configuration menu appears, press **TOOLS (F2)**.
- 5 Select **Check Address Books** and press **OK (F1)**.
- 6 Confirm that you want to perform the check. The digital sender shuts down and then checks the address book database as it restarts.

## Clearing the data base

You may want to clear the address book data base if:

- You are changing the digital sender's user base (e.g. moving the digital sender to a different department)
- The address book has become corrupt and checking the address books ([see page 39](#)) has not corrected the problem

---

### CAUTION

---

Clearing the address book data base will erase all user profiles, e-mail addresses, e-mail lists, fax numbers, and fax lists.

## To clear the address book data base

- 1 At the control panel, press **SETUP (ALT + F4)**.
- 2 Select any configuration menu. If an administrator password is required, the **HP Digital Sender 8100C Administrator's Password** dialog box appears. Type the password and press **OK (F1)**.
- 3 When the configuration menu appears, press **TOOLS (F2)**.
- 4 Select **Clear data base**.
- 5 The confirmation dialog box appears. Press **OK** to clear the data base. Press **CANCEL** to exit.
- 6 The data base is cleared and the digital sender re-starts.

## B/W Contrast

If e-mail or i-fax documents sent by the digital sender appear too light or too dark, the problem may be solved by adjusting the contrast. Use this feature much the same way you would use a similar function on a photocopier: decreasing the contrast lightens the scan of the image, increasing the contrast darkens it.

### To change the contrast for sending

- 1 At the control panel, press **SETUP** (ALT + F4). Then press **SETTINGS** (F2).
- 2 Select any of the configuration menus. If an administrator password is required, the **HP Digital Sender 8100C Administrator's Password** dialog box appears. Type the password and press **OK** (F1).
- 3 When the configuration menu appears, press **TOOLS** (F2).
- 4 Select **B/W Contrast** and press **OK** (F1).
- 5 By default, the digital sender is set to Automatic. Press **ENTER**, then use ▲ and ▼ to switch to Manual. Press **ENTER**.
- 6 Use ◀ or ▶ to move to the contrast bar. Move the marker to the left to lighten the contrast, move the marker to the right to darken the contrast.
- 7 Press **SAVE** (F1).

---

#### Note

---

In general, the **B/W Contrast** setting should be kept on Automatic unless a contrast adjustment is necessary to improve readability.

## Creating and maintaining user profiles

This section contains information about user profiles that pertains to the administrator. See the user guide for details on other uses.

The administrator determines who can create and modify user profiles in these ways:

- If Allow user self-registration in the **General** configuration menu is on, users can create and modify their own profile. The administrator can see and modify any user profile, including user passwords.
- If Allow user self-registration in the **General** configuration menu is off, only the administrator can create and modify user profiles, including user passwords.
- The administrator can also enable or disable guest usage of the digital sender (**General** configuration menu). If disabled, anyone wishing to use the digital sender would be required to have a user profile.

### To create a user profile

- 1 At the control panel, press **SETUP (ALT + F4)**. Then press **USERS (F1)**.
- 2 If an administrator password is required, the **HP Digital Sender 8100C Administrator's Password** dialog box appears. Type the password and press **OK (F1)**.
- 3 Type a name in the Users field and press **ADD (F1)**.

---

#### Note

---

You may want to use a naming convention for all user names, such as last name\_first name or first name\_last name.

- 4 Type the user's e-mail address, password, and password confirmation, pressing **ENTER** after each field.
- 5 Press **OPTIONS (F2)** and select **Yes (F1)** or **No (F4)** for each option in the user profile.
- 6 Press **OK (F1)**. The user profile can now be used to send e-mail, send faxes, and print.

## To change a user profile

- 1 At the control panel, press **SETUP (ALT + F4)**. Then press **USERS (F1)**.
- 2 If an administrator password is required, the **HP Digital Sender 8100C Administrator's Password** dialog box appears. Type the password and press **Ok (F1)**.
- 3 Select a name in the list of users by using the arrow keys or type the profile name in the Users field and press **MODIFY (F3)**.
- 4 Modify the name, e-mail address, password, and password confirmation, pressing **ENTER** after each field.
- 5 Press **OPTIONS (F2)** and select **YES (F1)** or **NO (F4)** for each option in the user profile.
- 6 Press **Ok (F1)**.

## To delete a user profile

- 1 At the control panel, press **SETUP (ALT + F4)**. Then press **USERS (F1)**.
- 2 If an administrator password is required, the **HP Digital Sender 8100C Administrator's Password** dialog box appears. Type the password and press **Ok (F1)**.
- 3 Highlight a name in the list of users or type the profile name in the Users field and press **DELETE (F3)**.
- 4 Press **Ok (F1)** to delete the user profile. Press **CANCEL (F4)** to return to the Users screen without deleting the profile.

---

**CAUTION**

Deleting a user profile also deletes that user's address book.

## Working with address books

This section contains information about address books that pertains to the administrator.

The administrator maintains these categories in the **LISTS** option of the **SETUP (ALT + F4)** menu:

- **Public E-mail Lists**  
Contains predefined groups of e-mail addresses available to any user. Only the administrator can change information in this address book.
- **Public E-mail Addresses**  
Contains e-mail addresses available to any user. Only the administrator can change information in this address book.
- **User's E-mail Lists**  
Contains a registered user's predefined groups of e-mail addresses. The user can change information in this address book through the **LISTS** option of the main menu.
- **User's E-mail Addresses**  
Contains e-mail addresses available to the registered user. The user can change information in this address book through the **LISTS** option of the main menu.
- **Fax Lists**  
Contains predefined groups of fax numbers available to any registered user. The user can change information in this address book through the **LISTS** option of the main menu.
- **Fax Numbers**  
Contains fax numbers available to any registered user. The user can change information in this address book through the **LISTS** option of the main menu.

## Maintaining the Public Lists address book

Only the administrator can change information in the Public Lists address book.

### To add a list to the Public Lists address book

- 1 Press **SETUP** (ALT + F4), then **LISTS** (F3).
- 2 Select **Public E-mail Lists**.
- 3 If an administrator password is required, the **HP Digital Sender 8100C Administrator's Password** dialog box appears. Type the password and press **OK** (F1).
- 4 Type the name for the distribution list.
- 5 Press **ENTER**.
- 6 Press **OK** (F1) to add the new list.
- 7 Type an address to add to the list and press **ENTER**.
- 8 Edit the information for the address and click **SAVE** (F1).
- 9 Repeat steps 7 and 8 for each address to add to the list.

### To delete a list from the Public Lists address book

- 1 Press **SETUP** (ALT + F4), then **LISTS** (F3).
- 2 Select **Public E-mail Lists**.
- 3 If an administrator password is required, the **HP Digital Sender 8100C Administrator's Password** dialog box appears. Type the password and press **OK** (F1).
- 4 Type a list name or choose the distribution list name from the list.
- 5 Press **DELETE** (F3).
- 6 Press **OK** (F1) to confirm.

## To add addresses to a distribution list

- 1 Press **SETUP** (**ALT + F4**), then **LISTS** (**F3**).
- 2 Select **Public E-mail Lists**.
- 3 If an administrator password is required, the **HP Digital Sender 8100C Administrator's Password** dialog box appears. Type the password and press **OK** (**F1**).
- 4 Select the distribution list you want to edit.
- 5 Press **OK** to modify the list.
- 6 Type an address to add to the list and press **ENTER**.
- 7 Edit the information for the address and click **SAVE** (**F1**).
- 8 Repeat steps 6 and 7 for each address to add to the list.

## To delete addresses from a distribution list

- 1 Press **SETUP** (**ALT + F4**), then **LISTS** (**F3**).
- 2 Select **Public E-mail Lists**.
- 3 If an administrator password is required, the **HP Digital Sender 8100C Administrator's Password** dialog box appears. Type the password and press **OK** (**F1**).
- 4 Select the distribution list you want to edit.
- 5 Press **OK** (**F1**) to modify the list.
- 6 Select the addresses.
- 7 Press **DELETE** (**F3**).
- 8 Press **OK** (**F1**) to confirm the deletion.



## Maintaining the Public E-mail address book

Only the administrator can change information in the Public E-mail address book.

### To add an address to the Public E-mail address book

- 1 Press **SETUP** (ALT + F4), then **LISTS** (F3).
- 2 Select **Public E-mail Adresse** .
- 3 If an administrator password is required, the **HP Digital Sender 8100C Administrator's Password** dialog box appears. Type the password and press **OK** (F1).
- 4 Add an address by doing one of the following:
  - Type a name for this entry in the **Name** field and press **ADD** (F1).
  - If the digital sender is set to work with an LDAP server, begin typing the first letters of an entry and press **SEARCH** (F2). Use the **▲** and **▼** keys to select an entry and press **OK** (F1).
- 5 Change the name and e-mail information for this entry as necessary. Use **TAB** to move between fields.
- 6 Press **SAVE** (F1).
- 7 Repeat steps 4 through 6 for each address you want to add.
- 8 When finished, click **SAVE** (F1).

### To delete an address from the Public E-mail address book

- 1 Press **SETUP** (ALT + F4), then **LISTS** (F3).
- 2 Select **Public E-mail Adresse** .
- 3 If an administrator password is required, the **HP Digital Sender 8100C Administrator's Password** dialog box appears. Type the password and press **OK**.
- 4 Type a display name or choose the address from the list using the arrow keys.
- 5 Press **DELETE** (F3).
- 6 Press **OK** (F1) to confirm.

---

**CAUTION**

Deleting an address from the public e-mail address book also deletes that address from all public and personal distribution lists.

## Maintaining user lists and addresses

To add, modify, or delete the addresses and lists for a particular registered user, follow the procedures in [“Maintaining the Public E-mail address book” on pag e47](#) and [“Maintaining the Public Lists address book” on pag e45](#) with the following provisions:

- Select User’s E-mail Lists or User’s E-mail Addresses from **LISTS**.
- Between steps 3 and 4, enter the user name.

## Maintaining fax lists and numbers

Users and the administrator have access to fax lists and numbers. To add, modify, or delete fax lists and numbers, follow the procedures in the user guide with the following provisions:

- Press **SETUP (ALT + F4)**, then **LISTS (F3)** to access the fax lists and fax numbers.
- The digital sender will not ask for a user name.

## Changing the contrast level of the LCD

Use this procedure to change the contrast of the display on the control panel. You might want to do this, for example, to adjust for lighting conditions in your office.

### To change contrast level

You can change the contrast level at any time. The digital sender does not need to be idle.

At the control panel, press the following while at the main menu or during login:

- SHIFT + ALT + ▲** (decreases)
- SHIFT + ALT + ▼** (increases)

# Upgrading the digital sender firmware

If you register with the digital sender website (<http://www.digitalsender.hp.com>), you will be notified by e-mail when a firmware upgrade is available for the digital sender.

Notes about the procedure:

- When you upgrade the digital sender firmware, you replace the existing firmware image with one or more new files.
- The digital sender is locked from use until the upgrade has finished.
- This procedure causes the digital sender to shut down and restart.
- The upgrade interrupts any job in progress.
- If the digital sender detects a problem with the new firmware version, it automatically reverts to the old version.
- The upgrade takes from 1 to 5 minutes.

## To upgrade the digital sender firmware

- 1 Download the firmware upgrade file from the digital sender website (<http://www.digitalsender.hp.com>) to a computer which shares the network with the digital sender.
- 2 Follow the instructions on the website for upgrading the firmware image.

At the end of the procedure, you are notified of the upgrade's success or failure.

## Backing up and restoring the digital sender

The Backup and Restore utilities save and recover the configuration of all personal and public address books, and the configuration of the digital sender. These utilities are stored in the \Utility folder on the product CD and must be installed on a computer on the same network as the digital sender.

### To install the Backup and Restore utilities

- 1 On the product CD, browse to the Utilities folder.
- 2 Review the Readme.txt file
- 3 Run Install.bat. The utilities are installed to C:\VP9100C\Utilities.

---

**Note**

---

Backup and Restore are command line programs which can be run from a .bat or .cmdfile.

### Backing up the digital sender

Use this procedure:

- After configuring the digital sender, creating users, and configuring public and personal address books
- Periodically to ensure recoverability of the digital sender to a desired state
- Before performing firmware upgrades

Backup saves the configuration of the digital sender to a .tgz file on your hard drive.

### To back up the digital sender

- 1 Make sure the computer you are using has the Backup and Restore utilities installed.
- 2 At a command line, run Backup using the following syntax:  

```
backup.exe /dir:Backup Directory /d:Digital Sender  
/p:Administrator Password /l/tr
```

---

**Note**

---

Example: backup.exe /dir:c:\data /d:xxx.xxx.xxx.xxx /p:password /l /tr

## Restoring the digital sender

Use this procedure:

- After initializing the address books
- After performing a Restore to factory defaults
- When instructed to do so by HP Customer Support

### Note

This procedure will erase any changes made to the address books and configurations since a backup image was created.

## To restore the digital sender

- 1 Make sure the computer you are using has the Backup and Restore utilities installed.
- 2 At a command line, run Restore using the following syntax:  

```
restore.exe /f:Restore File /d:Digital Sender
/p:Administrator Password /l/tr
```

### Note

Example: `restore.exe /f:c:\data\data.tgz /d:xxx.xxx.xxx.xxx /p:password /l /tr`

## Backup and Restore code

Source	Description
/dir	Directory must be in a volume supporting long file names.
/d	Digital sender network name or IP address.
/p	Digital sender administrator password.
/l	Log results in log file (backup.log or restore.log).
/tr	Log low level activity in trace file (backup.trc or restore.trc).
/f	Restore file, generated by previous backup.

## Cleaning the digital sender

### Digital Sender glass

When to clean:

- as necessary
- when vertical streaks appear on electronic forms of sent documents

### To clean the glass

Clean the glass surface gently using a soft cloth. Do not press hard on the glass surface (you could break the glass). You may dampen the cloth with water, isopropyl alcohol, or window cleaner, if necessary.

---

**CAUTION**

---

Do not use other cleaning fluids. They may damage the digital sender. Never spray cleaning fluid directly on the digital sender glass.

## ADF

When to clean:

- if paper documents in good condition begin to mis-feed
- when vertical streaks appear on electronic forms of sent documents

1

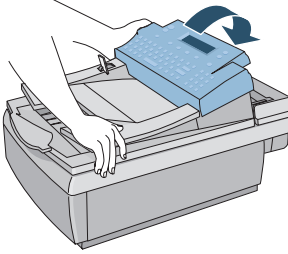

2

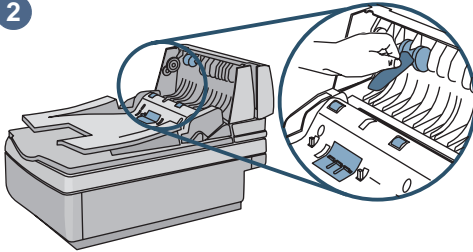

4

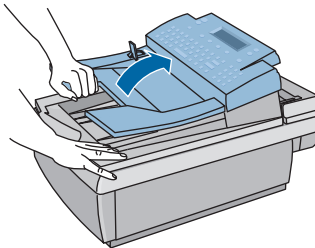

5

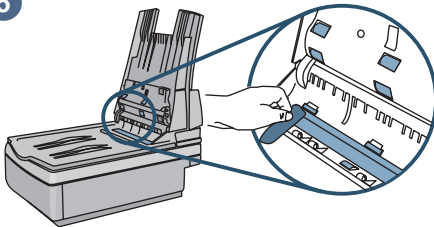

## To clean the ADF

- 1 Raise the control panel access hatch.
- 2 Wipe the rollers and separation pad with a soft, clean, lint-free cloth. You may dampen the cloth with isopropyl alcohol, if necessary.
- 3 Close the access hatch. Be sure it snaps down on both sides.
- 4 Raise the input tray.
- 5 Wipe the top of the ADF window (the clear plastic window) and rollers with a soft, clean, lint-free cloth. You may dampen the cloth with water, isopropyl alcohol, or window cleaner, if necessary.

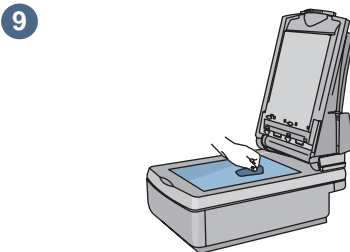
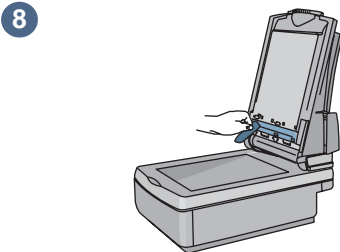
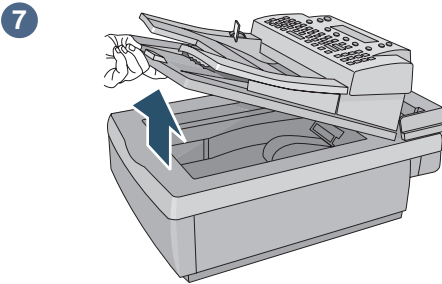
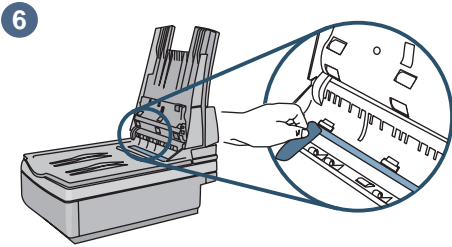

6 Check the flat gray bar above the ADF window. The bar should have no black or other markings. If necessary, clean the flat gray bar.

7 Raise the output tray.

8 Wipe the bottom of the ADF window (the clear plastic window) with a soft, clean, lint-free cloth. You may dampen the cloth with water, isopropyl alcohol, or window cleaner, if necessary.

9 To eliminate vertical streaks, clean the flatbed glass, especially near the top of the glass.

---

### CAUTION

Do not use other cleaning fluids. They may damage the ADF window. Never spray cleaning fluid directly on the ADF.

---



# 4 Troubleshooting

## Sources for information about problems

### Sources for information about problems

Source	Description
Control panel messages	Messages on the control panel display when there are problems. See <a href="#">“Control panel messages” on pag e56</a> for a list of messages and recommended actions.
Job(s) state	This screen reveals the status of the last five jobs processed by the digital sender. See <a href="#">“Job(s) state” on pag e33</a> for details.
Revision pag	The Revision page that you can display at the control panel is an important troubleshooting tool. Ability to display the page indicates that the digital sender is operating correctly. Information on the page reveals the status of your network and the network interface card. The page is also your reference for information about firmware versions and product numbers (sometimes needed when you contact H Pcustomer support). See <a href="#">“Revision page” on page 34</a> for details.

# Troubleshooting the digital sender

## General digital sender troubleshooting

Use the table in the user guide to solve common problems encountered while using the digital sender. Contact HP customer support ([see pag e67](#)) if the actions suggested there do not resolve the problem.

## Control panel messages

The following table lists the messages the control panel might display which may require the administrator's attention. The table also lists the cause of the message, and recommended actions. See the user guide for other control panel messages.

### Note

The messages are listed in alphabetical order. Messages that report normal status are not included.

### Control panel messages

Message	Description	Actions
AB Error <i>codes</i> .	An internal problem in accessing address books has occurred.	<ul style="list-style-type: none"> <li>● Turn the digital sender off and then back on.</li> <li>● Perform a database check (see "<a href="#">Checking the address book database</a>" on pag e39).</li> <li>● If the problem persists, note the error codes and contact HP customer support.</li> </ul>
The default "From" e-mail address is not set. Cannot send e-mail messages if "From" field is not provided either at control panel or in registered user profile.	A default <b>FROM</b> e-mail address is missing from the configuration.	<ul style="list-style-type: none"> <li>● Use the <b>E-mail</b> configuration menu to configure the default <b>FROM</b> e-mail address.</li> <li>● If the problem persists, contact HP customer support.</li> </ul>
The DNS configuration is inconsistent. Please check	There is a problem with the DNS (Domain Name System) configuration.	<ul style="list-style-type: none"> <li>● Using the <b>Network</b> configuration menu, make sure that you have correctly configured a DNS server and default domain.</li> <li>● Try reentering the information in the configuration menu.</li> <li>● If the problem persists, contact HP customer support.</li> </ul>

**Control panel messages (continued)**

<b>Message</b>	<b>Description</b>	<b>Actions</b>
The e-mail configuration is inconsistent. Please check	There is a problem with the e-mail configuration.	<ul style="list-style-type: none"> <li>● Using the <b>E-mail</b> configuration menu, make sure that you have correctly configured the e-mail server address and e-mail default <b>FROM</b> address.</li> <li>● Try reentering the information in the <b>Network</b> configuration menu.</li> <li>● Turn the digital sender off and then back on.</li> <li>● If the problem persists, contact HP customer support.</li> </ul>
The e-mail function isn't configured. Please contact the administrator or refer to the documentation	There is a problem with the e-mail configuration.	<ul style="list-style-type: none"> <li>● See <a href="#">"Configure e-mail parameters" on page 20</a>.</li> </ul>
E-mail server not available. Contact the administrator.	You selected the e-mail function, but the e-mail server is turned off or cannot be reached.	<ul style="list-style-type: none"> <li>● Turn the digital sender off and then on again.</li> <li>● Make sure all cabling is securely connected.</li> <li>● Make sure the e-mail server is running and can be reached from the portion of the network on which the digital sender is installed.</li> <li>● Make sure the network interface card is communicating with the network. To do this, verify that the TCP/IP status parameter on the Revision page reads <b>READY</b>, and then try to reach the digital sender using a network command such as ping.</li> </ul>
Errors were found when checking the address book. Initialize address book	An internal check of the address book database found significant problems.	<ul style="list-style-type: none"> <li>● Reset address books by answering "Yes" to the control panel question. Wait for the reset to complete and then restore a backup copy of the address book.</li> </ul>
The I-fax configuration is inconsistent. Please check	There is a problem with the I-fax configuration.	<ul style="list-style-type: none"> <li>● Using the <b>I-fax</b> configuration menu, make sure that you have correctly configured the I-fax domain, fax account e-mail address, fax prefix and/or fax postage.</li> <li>● Try reentering the information in the <b>Network</b> configuration menu.</li> <li>● Turn the digital sender off and then back on.</li> <li>● If the problem persists, contact HP customer support.</li> </ul>
The i-fax function isn't configured. Please contact the administrator or refer to the documentation.	There is a problem with the i-fax configuration.	<ul style="list-style-type: none"> <li>● See <a href="#">"Configure I-fax parameters" on page 21</a>.</li> </ul>

## Control panel messages (continued)

Message	Description	Actions
Internal error. <i>codes</i> Digital Sender halted .	Internal problem.	<ul style="list-style-type: none"> <li>● See the internal error table starting on <a href="#">page 61</a>.</li> </ul>
Invalid credentials. Check account name and passw ord.	The account name and password that have been configured for authenticating LDAP searches are invalid.	<ul style="list-style-type: none"> <li>● Use the <b>E-mail</b> configuration menu at the control panel to change the account name and password.</li> </ul>
Invalid password. Press any key to retry.	The digital sender did not recognize the password you entered.	<ul style="list-style-type: none"> <li>● Press any key and then retype the password. The password is case-sensitive, so make sure you type the right combination of uppercase and lowercase letters.</li> <li>● If the problem persists see "<a href="#">Erasing administrator password</a>" on <a href="#">pag e31</a>.</li> </ul>
JetDirect not responding. Please check the card or the firmware version.	The firmware version of the HP JetDirect print server (interface card) installed in the digital sender is not compatible with the product.	<ul style="list-style-type: none"> <li>● Contact HP customer support.</li> </ul>
The LDAP configuration is inconsistent. Please check.	There is a problem with the LDAP configuration.	<ul style="list-style-type: none"> <li>● Using the <b>E-mail</b> configuration menu, make sure that you have correctly configured the LDAP server</li> <li>● Try reentering the information in the <b>E-mail</b> configuration menu.</li> <li>● Turn the digital sender off and then back on.</li> <li>● If the problem persists, contact HP customer support.</li> </ul>
LDAP protocol error.	The LDAP search could not complete because of a problem with a network connection or LDAP server.	<ul style="list-style-type: none"> <li>● Turn the digital sender off and then back on.</li> <li>● Check that the other functions of the digital sender are working.</li> <li>● Make sure the LDAP server is functioning properly</li> <li>● If the problem persists, contact HP customer support.</li> </ul>

## Control panel messages (continued)

Message	Description	Actions
The LDAP server is currently unreachable. Contact the administrator	There is a problem with either the LDAP server or the network.	<ul style="list-style-type: none"> <li>● Try again later.</li> <li>● Check that all cabling is securely connected.</li> <li>● Using the <b>Network</b> and <b>E-mail</b> configuration menus, make sure you have correctly configured all TCP/IP addresses, the LDAP server name, and (optionally) the LDAP port number.</li> <li>● If you use symbolic names, make sure you have correctly configured a DNS or WINS server in the <b>Network</b> configuration menu.</li> <li>● Check that the network is working correctly using a network command such as ping.</li> <li>● Check with the LDAP server administrator to make sure the LDAP server is running.</li> <li>● Check that the network is properly configured.</li> <li>● If the problem persists, contact HP customer support.</li> </ul>
Network error <i>code</i> .	There is a problem with the network interface card.	<ul style="list-style-type: none"> <li>● Turn the digital sender off and then back on.</li> <li>● Check the TCP/IP status parameter on the Revision page. If it displays <b>RED</b> , try reaching the digital sender using a network command such as ping. If it displays <b>ERROR</b>, note the codes and contact HP customer support.</li> </ul>
No matches found .	There is no entry in the LDAP directory that matches your search string and search criteria.	<ul style="list-style-type: none"> <li>● Check the accuracy of your search string and search criteria.</li> </ul>
Object not found. Check your configuration	Either the search root or the name/password combination for authenticating searches in the LDAP server is incorrect.	<ul style="list-style-type: none"> <li>● Use the <b>E-mail</b> configuration menu at the control panel to correct the search root or name/password combination.</li> </ul>
Partial results. Check your configuration	The search root for searches in the LDAP server is incorrect.	<ul style="list-style-type: none"> <li>● Use the <b>E-mail</b> configuration menu at the control panel to correct the search root.</li> </ul>
Passwords do not match. Press any key to retry.	During the procedure to change password, the confirming password that was entered did not match the first password.	<ul style="list-style-type: none"> <li>● Try again.</li> </ul>

## Control panel messages (continued)

Message	Description	Actions
Search error.	An unexpected problem occurred in the LDAP search (for example, memory shortage, or problem with the network link or LDAP server).	<ul style="list-style-type: none"> <li>● Try the search again.</li> <li>● Turn the digital sender off and then back on.</li> <li>● If the problem persists, contact HP customer support.</li> </ul>
Sorry, you have typed an incorrect password. Please retype your password.	The digital sender did not recognize the password you typed.	<ul style="list-style-type: none"> <li>● Press any key to clear the message, and then retype the password. Passwords are case-sensitive, so make sure you enter the correct combination of lowercase and uppercase letters.</li> <li>● Check the user profile for the password.</li> </ul>
This operation can require several minutes. Do you really want to proceed?	You are being asked to confirm that you want to check the address book database.	<ul style="list-style-type: none"> <li>● Press <b>OK</b> to continue with the database check or press <b>CANCEL</b> to cancel. If you continue, the digital sender shuts down and restarts.</li> </ul>
This user is not registered. Please add them.	The user needs a user profile.	<ul style="list-style-type: none"> <li>● See <a href="#">“Creating and maintaining user profiles” on page 42</a>.</li> </ul>
This will clear the configuration and all the destinations. Do you really want to proceed?	You are being asked to confirm that you want to reset the digital sender to the factory defaults.	<ul style="list-style-type: none"> <li>● Press <b>OK</b> to continue with the reset or press <b>CANCEL</b> to cancel.</li> </ul>
This will clear your changes. Do you really want to proceed?	You are being asked to confirm that you want to discard all changes that you have made in the configuration menu.	<ul style="list-style-type: none"> <li>● Press <b>OK</b> to discard your changes; this takes you out of the configuration menu. Press <b>CANCEL</b> to return to the configuration menu, where you can use <b>SAVE</b> to save the changes before exiting.</li> </ul>
The user name you typed was not found. Contact the administrator.	The digital sender did not recognize the user name you entered.	<ul style="list-style-type: none"> <li>● Make sure the name is correct and try again.</li> </ul>
The WINS configuration is inconsistent. Please check.	There is a problem with the WINS (Windows Internet Naming Service) configuration.	<ul style="list-style-type: none"> <li>● Try reentering the information in the <b>Network</b> configuration menu.</li> <li>● If the problem persists, contact HP customer support.</li> </ul>
You do not have sufficient access rights.	The account name used to authenticate searches with LDAP server has insufficient rights to access the information.	<ul style="list-style-type: none"> <li>● Use the <b>E-mail</b> configuration menu at the control panel to change the account name and password.</li> </ul>

### Control panel messages (continued)

Message	Description	Actions
You need to become a registered user to use this digital sender. Please contact your admin.	<b>Allow user self-registration</b> in the <b>General</b> configuration menu is disabled.	<ul style="list-style-type: none"> <li>● The administrator must add the user. See <a href="#">“Creating and maintaining user profiles” on page 42</a></li> <li>● Enable <b>Allow user self-registration</b>.</li> </ul>

### Internal error message descriptions and action

Code	Description	Actions
<p><b>NOTE</b> Every internal error message has a code associated with it. Use the code to locate the description and action.</p>		
5,xxxxx	Internal software or hardware problem	<ul style="list-style-type: none"> <li>● Turn the digital sender off and then back on.</li> <li>● Verify control panel access hatch is snapped into place.</li> <li>● Verify all cables are seated securely.</li> <li>● If the problem persists, note the code and contact HP customer support.</li> </ul>
7,xxxxx	Internal failure	<ul style="list-style-type: none"> <li>● Turn the digital sender off and then back on.</li> <li>● Reconfigure all network parameters.</li> <li>● If the problem persists, note the code and contact HP customer support.</li> </ul>
10,0	Failure initializing address books.	<ul style="list-style-type: none"> <li>● Turn the digital sender off and then back on.</li> <li>● Check the address book database (see <a href="#">“Checking the address book database” on page 39</a>).</li> <li>● Clear the address book.</li> <li>● Reset the digital sender to factory defaults (see <a href="#">“Resetting to factory defaults” on page 39</a>).</li> </ul> <p>NOTE: This also erases the administrator password, all TCP/IP configuration, and all public and personal address books.</p> <ul style="list-style-type: none"> <li>● If the problem persists, note the code and contact HP customer support.</li> </ul>

# Troubleshooting network problems

## Network interface card troubleshooting

Several parameters on the Revision page provide helpful information about the print server. In particular, the TCP/IP status parameter indicates whether the print server is actively connected to the network or whether an error condition exists.

See [“Revision page” on page e34](#) for a description of all parameters and for steps on how to access the Revision page.

If the digital sender fails to connect to the network, verify the following information is correctly entered in the **Network** configuration menu.

- IP address
- IP subnet mask
- IP gateway

Refer to <http://www.digitalsender.hp.com> for advanced network troubleshooting guides.



# 5 Warranty and support information

## Hewlett-Packard limited warranty statement

HP PRODUCT	DURATION OF WARRANTY
HP Digital Sender 8100C	One year

- 1** HP warrants HP hardware, accessories, and supplies against defects in materials and workmanship for the period specified above. If HP receives notice of such defects during the warranty period, HP will, at its option, either repair or replace products which prove to be defective. Replacement parts may be either new or like-new.
- 2** HP warrants that HP software will not fail to execute its programming instructions, for the period specified above, due to defects in material and workmanship when properly installed and used. If HP receives notice of such defects during the warranty period, HP will replace software media which does not execute its programming instructions due to such defects.
- 3** HP does not warrant that the operation of HP products will be uninterrupted or error free. If HP is unable, within a reasonable time, to repair or replace any product to a condition as warranted, customer will be entitled to a refund of the purchase price upon prompt return of the product.
- 4** HP products may contain remanufactured parts equivalent to new in performance or may have been subject to incidental use.
- 5** The warranty period begins on the date of the delivery or on the date of installation if installed by HP. If customer schedules or delays HP installation more than 30 days after delivery, warranty begins on the 31st day from delivery.

- 6 Warranty does not apply to defects resulting from improper or inadequate maintenance or calibration, software, interfacing, parts or supplies not supplied by HP, unauthorized modification or misuse, operation outside of the published environmental specifications for the product, or improper site preparation or maintenance.

---

**Note**

---

Operation of the digital sender beyond the limit of its nominal duty cycle (scanning greater than the equivalent of 3300 pages per month) shall be deemed digital sender abuse and all repairs thereafter are to be billed on a time-and-materials basis.

- 7 TO THE EXTENT ALLOWED BY LOCAL LAW, THE ABOVE WARRANTIES ARE EXCLUSIVE AND NO OTHER WARRANTY, WHETHER WRITTEN OR ORAL, IS EXPRESSED OR IMPLIED AND HP SPECIFICALLY DISCLAIMS THE IMPLIED WARRANTIES OF MERCHANTABILITY, SATISFACTORY QUALITY, AND FITNESS FOR A PARTICULAR PURPOSE.
- 8 HP will be liable for damage to tangible property per incident up to the greater of \$300,000 or the actual amount paid for the product that is the subject of the claim, and for damages for bodily injury or death, to the extent that all such damages are determined by a court of competent jurisdiction to have been directly caused by a defective HP product.
- 9 TO THE EXTENT ALLOWED BY LOCAL LAW, THE REMEDIES IN THIS WARRANTY STATEMENT ARE THE CUSTOMER'S SOLE AND EXCLUSIVE REMEDIES. EXCEPT AS INDICATED ABOVE, IN NO EVENT WILL HP BE LIABLE FOR LOSS OF DATA OR FOR DIRECT, SPECIAL, INCIDENTAL, CONSEQUENTIAL (INCLUDING LOST PROFIT OR DATA), OR OTHER DAMAGE, WHETHER BASED IN CONTRACT, TORT, OR OTHERWISE.
- 10 FOR CONSUMER TRANSACTIONS IN AUSTRALIA AND NEW ZEALAND; THE WARRANTY TERMS CONTAINED IN THIS STATEMENT, EXCEPT TO THE EXTENT LAWFULLY PERMITTED, DO NOT EXCLUDE, RESTRICT OR MODIFY AND ARE IN ADDITION TO THE MANDATORY STATUTORY RIGHTS APPLICABLE TO THE SALE OF THIS PRODUCT TO YOU.

## Hewlett-Packard Year 2000 warranty

Subject to all of the terms and limitations of the HP Limited Warranty Statement provided with this HP Product, HP warrants that this HP product will be able to accurately process date data (including, but not limited to, calculating, comparing, and sequencing) from, into, and between the 20th and 21st centuries, and the year 1999 and 2000, including leap year calculations, when used in accordance with the Product documentation provided by HP (including any instructions for installing patches or upgrades), provided that all other products (e.g., hardware, software, firmware) used in combination with such HP product(s) properly exchange date data. The duration of the Year 2000 warranty extends through January 31, 2001.

## Replacement parts and accessories

You can obtain replacement parts for your HP Digital Sender 8100C by contacting your sales representative or your Hewlett-Packard dealer.

### Replacement parts and accessories

<b>Item</b>	<b>Part or product number</b>
Documentation CD-ROM (full set)	C7707-60009
Welcome Poster	C7707-90004
Welcome Poster (Eastern Europe)	C7707-90015
ADF window	C5195-1611
Bumper foot	C4557-4118
Control panel clip	C7707-40005

## HP customer support options worldwide

You can call HP for support using the table below. For all other support information, such as obtaining printer drivers or help using an online server, see [“HP support” on page 69](#). If you need a replacement part or information not listed in one of these two tables, see the administrator guide .

---

### Customer Support and Product Repair Assistance for the U.S. and Canada (See the administrator guide for additional product repair information.)

Call (1) (208) 323-2551 in the U.S. Monday through Friday from 6 am to 6 pm (Mountain Time) free of charge for 90 days. The 90-day period begins with the first support call, and it must be within the one-year hardware warranty period. However, your standard long-distance phone charges still apply. Have your product nearby and your serial number ready when calling.

After your free telephone-support period has expired, fee-based telephone assistance is available to answer your product questions. Call (1) (900) 555-1500 (\$2.50\*per minute, U.S. only) or call 1-800-999-1148 (\$25\* per call, Visa or MasterCard, U.S. and Canada) Monday through Friday from 7 am to 6 pm and Saturday from 9 am to 3 pm (Mountain Time). *Charges begin only when you connect with a support technician. \*Prices subject to change.*

---

### European Customer Support Center Language and In-Country Options Available

Open Monday through Friday 8:30–18:00 CET (*unless otherwise noted*)

HP provides a free telephone support service for 90 days, beginning with the first support call, but it must be within the one-year warranty period. By calling a telephone number listed below, you will be connected to a responsive team waiting to help you. If you require support after your 90-day free phone support has expired, you can receive support for a fee through the same telephone number. The fee is charged on a per-incident basis. When calling HP, have the following information ready: product name and serial number, date of purchase, and description of the problem.

<b>English</b>	Ireland: +353 (0)1 662 5525 U.K.: +44 (171)512-5202 International: +44 (0)171 512 52 02	<b>Hebrew</b>	+972 (0)9 9524848 (09:00-18:00 CET Sunday-Thursday)
<b>Czech</b>	+42 (0)26130 7310 (08:00-18:00 Monday-Thursday; 08:00-16:30 Friday)	<b>Hungarian</b>	+36 (0)1 321 111
<b>Danish</b>	(45) 3929-4099	<b>Italian</b>	Italy: +39 02 264 10350
<b>Dutch</b>	Belgium: +32 (0)2 626 8806 Netherlands: +31 (0)20 606 8751	<b>Norwegian</b>	+47 22 11 6299
<b>Finnish</b>	+358 (0)203 47 288	<b>Polish</b>	+351 (0)1 3176333
<b>French</b>	Belgium: +32 (0)2 626 8807 France: +33 (0)1 43 62 34 34	<b>Portuguese</b>	Portugal: +7 095 797 3520 (09:00-18:00 CET)
<b>German</b>	Germany: +49 (0)180 52 58 143 (24PF/min) Austria: +43 (0)7114201080	<b>Russian</b>	+27 86 000 1030 (08:00-17:00 CET)
<b>Greek</b>	+30 (0)1 6854 11 (09:00-17:00 CET)	<b>Spanish</b>	Spain: +46 (0)86192170
		<b>Swedish</b>	+41 (0)84801 11
		<b>Switzerland</b>	+90212 224 59 25
		<b>Turkey</b>	+44 (0)171 512 52 02

---

**All other countries worldwide:** Use the telephone number below for your country to obtain support during the warranty period. If you require support after your warranty has expired, additional product repair services, or if your country is not listed below, see the administrator guide.

Argentina	(541) 778 8380	Japan	+ 81 3 3335-8333
Australia	+ 61 3 8877-8000	Malaysia	+ 60 (3) 295 2566
Brazil	(011) 829 6612	Mexico	01 800 472 6684
Canada	(1) (905) 206-4663	Middle East/Africa	(41) (22) 780711
China	+ 86 (0)10 6564 5959	New Zealand	+ 64 (9) 356 6640
Chile	800 360 999	Philippines	+ 63 (2) 8673551
Hong Kong	+ 85 (2) 2802 4098	Singapore	+ 65 272 5300
India	+ 91 11 682-6035	South Africa	+ 34902 321 123
	+ 91 11 682-6069	Taiwan	+ 886 (2) 2717 0055
Indonesia	+ 62 (21) 350 3408	Thailand	+ 66 (2) 661 4000
Korea (Seoul)	+ 82 (2) 3270 0700	Venezuela	800 47 888
Korea (outside Seoul)	080 999-0700	Viet Nam	+ 84 (0) 8 823 4530

# HP support

<p><b>Online services:</b> for 24-hour access to information over your modem, we suggest these services:</p>	<p><b>World Wide Web URL</b> - Firmware upgrades, printer drivers, updated HP printer software, plus product and support information may be obtained from the following URLs:</p> <p>for HP Digital Sender 8100C <a href="http://www.digitalsender.hp.com">http://www.digitalsender.hp.com</a>  in the U.S. <a href="http://www.hp.com">http://www.hp.com</a>  in Europe <a href="http://www2.hp.com">http://www2.hp.com</a></p> <p>Printer drivers may be obtained from the following sites:</p> <p>in Japan <a href="ftp://www.jpn.hp.com/drivers">ftp://www.jpn.hp.com/drivers</a>  in Korea <a href="http://www.hp.co.kr">http://www.hp.co.kr</a>  in Taiwan <a href="http://www.hp.com.tw">http://www.hp.com.tw</a>  or the local driver website <a href="http://www.dds.com.tw">http://www.dds.com.tw</a></p> <p><b>America Online</b> - America Online/Bertelsmann is available in the U.S., France, Germany, and U.K. - Printer drivers, updated HP printer software, and support documentation to help answer your questions about HP products are available. Use Keyword HP to start your tour or call 1-800-827-6364 preferred customer #1118 to subscribe. In Europe, call the appropriate number below</p> <table data-bbox="462 763 911 911"> <tr> <td>Austria</td> <td>022 58 58 485</td> </tr> <tr> <td>France</td> <td>+353 1 704 90 00</td> </tr> <tr> <td>Germany</td> <td>0180531 31 64 (24PF/min)</td> </tr> <tr> <td>Switzerland</td> <td>0848 10 11</td> </tr> <tr> <td>United Kingdom</td> <td>0800 279 1234</td> </tr> </table>	Austria	022 58 58 485	France	+353 1 704 90 00	Germany	0180531 31 64 (24PF/min)	Switzerland	0848 10 11	United Kingdom	0800 279 1234
Austria	022 58 58 485										
France	+353 1 704 90 00										
Germany	0180531 31 64 (24PF/min)										
Switzerland	0848 10 11										
United Kingdom	0800 279 1234										
<p><b>Obtaining software utilities and electronic information:</b></p>	<p>See "<a href="#">HP customer support options worldwide</a>" on <a href="#">page 67</a>.</p>										
<p><b>HP direct ordering for accessories or supplies:</b></p>	<p>Call 1-800-538-8787 (U.S.) or 1-800-387-3154 (Canada).</p>										
<p><b>HP Support Assistant CD-ROM:</b></p>	<p>This support tool offers a comprehensive online information system designed to provide technical and product information on HP products. To subscribe to this quarterly service call 1-800-457-1762 in the U.S. or Canada; +31 555 384279 in Europe (0800 960 274 in the U.K.); (65) 740-4477 in the Asia/Pacific region; and 1-801-431-1587 in Latin America.</p>										
<p><b>HP Service Information:</b></p>	<p>To locate HP Authorized Dealers, call 1-800-243-9816 (U.S.) or 1-800-387-3867 (Canada).</p>										
<p><b>HP Service Agreements:</b></p>	<p>Call 1-800-835-4747 (U.S.) or 1-800-268-1221 (Canada).  Extended Service: 1-800-446-0522.</p>										
<p><b>Locating HP Resellers</b></p>	<p>Hewlett-Packard appliances, peripherals, personal computers, supplies, and accessories are available at HP authorized resellers worldwide. To find the one nearest to you, contact:</p> <p>United States: 1-877-DSENDER (373-6337)  Canada: 1-800-387-3867  Europe: <a href="http://www.hp.com">http://www.hp.com</a> and select Assistance and Other Countries</p>										





# A Specifications

## Equipment specifications

Feature	Description
Product type	<ul style="list-style-type: none"> <li>● Flatbed and sheetfed</li> </ul>
Scanning element	<ul style="list-style-type: none"> <li>● Charged-coupled device</li> </ul>
Light source	<ul style="list-style-type: none"> <li>● Cold Cathode Fluorescent Lamp (CCFL)</li> </ul>
Interface	<ul style="list-style-type: none"> <li>● Ethernet 10BaseT</li> </ul>
Optical resolution	<ul style="list-style-type: none"> <li>● 600 dpi (dots per inch)</li> </ul>
Maximum scanning speed	<ul style="list-style-type: none"> <li>● B/W sending quality: 4 pages per minute</li> <li>● Color sending quality: 3 pages per minute</li> <li>● Photo sending quality: 3.5 pages per minute</li> </ul>
Image processing	<ul style="list-style-type: none"> <li>● Black-and-white documents</li> <li>● Color documents</li> <li>● Color and black-and-white documents</li> <li>● High-resolution color and black-and-white photographs (print only)</li> </ul>
Compression	<ul style="list-style-type: none"> <li>● Software: HP Smart Compression Imaging technology utilizing CCIP, G4, and optimized JPEG compression</li> </ul>
AC line voltage	<ul style="list-style-type: none"> <li>● 100 to 240 Vac, 50 to 60 Hz</li> </ul>
Power consumption	<ul style="list-style-type: none"> <li>● 30 W idle</li> <li>● 38 W operating</li> </ul>
Noise pressure level	<ul style="list-style-type: none"> <li>● 56 dB when operating the flatbed</li> <li>● 68 dB when operating the ADF</li> </ul>
Weight	<ul style="list-style-type: none"> <li>● 10.9 kg (24.0 lb)</li> </ul>
Duty cycle	<ul style="list-style-type: none"> <li>● 3,300 pages per month</li> </ul>

Feature	Description
Control panel display	<ul style="list-style-type: none"><li>● 240-by-64 pixels graphic LCD</li><li>● Blue dots on silver-gray background</li></ul>
Keypad	<ul style="list-style-type: none"><li>● 40-key alphabetic keypad</li><li>● 12-key numeric keypad</li><li>● Help key</li><li>● Simplex/duplex key for single-sided or double-sided scanning</li><li>● Green “go” button and red “stop” button</li><li>● 4 context-sensitive function keys</li></ul>
Scan engine	<ul style="list-style-type: none"><li>● Full-color and grayscale ADF (automatic document feeder) and flatbed scans</li><li>● Image calibration</li><li>● Color and tonal adjustment</li><li>● Data scaling and enhancement</li></ul>
Automatic document feeder (ADF)	<ul style="list-style-type: none"><li>● 25-page capacity</li><li>● High feeding accuracy and reliability</li><li>● Variety of paper sizes and weights</li><li>● Correct order output</li><li>● Automatic start and stop at any speed</li></ul>

## Environmental ranges

<b>Temperature</b>	
Operating	10 to 35° C (50 to 95° F)
Storage	-40 to 60° C (-40 to 140° F)

<b>Humidity</b>	
Operating	10 to 80% noncondensing(10 to 35° C)
Storage	0 to 90%

### **CAUTION**

The operating environment should be stable, with no abrupt changes in temperature or humidity, or your digital sender might be damaged. If you move the digital sender from a cold to a warm environment, wait about two hours before using it.

## Supported capabilities

### Operating capabilities

Description	Maximum
Multiple selections at control panel (combination of each individual e-mail address and each distribution list)	128
Destinations for an e-mail message (combination of all individual e-mail addresses and all addresses in selected distribution lists)	1,024
Destinations for a fax transmission	1,024
Characters in a telephone number	80

### Memory capabilities

Description	Maximum
Users	4,096
Public e-mail addresses	200,000
Fax numbers	2,048
Size of public e-mail distribution list	512
Number of public e-mail distribution lists	512
Size of fax distribution lists	512
Number of fax distribution lists	512
Public HP JetSend-enabled printers	64
Size of personal e-mail address book	256
Number of personal distribution lists	100
Length of user's name	31
Length of display name	31
Length of user's password	15
Length of distribution list name	31
Length of fax number	79
Length of e-mail address	255

# Declarations of Conformity

## EU Declaration of Conformity

According to ISO/IEC Guide 22 and EN 45014

**Manufacturer's Name:** Hewlett-Packard Company

**Manufacturer's Address:** Greeley Hardcopy Division  
700 71st Avenue  
Greeley, Colorado 80634  
USA

Declares that the product

**Product Name:** HP Digital Sender 8100C  
**Model Numbers:** C7707 (may contain suffix)  
**Product Options:** C7707

**Conforms to the following specifications:**

SAFETY	IEC 950:1991+A1:1992+A2:1993+A3:1995+A4:1996	
	EN 60950:1992 +A1:1992+A2:1993+A3:1995+A4:1997+A11:1997	
	EN 60825-1:1994 Class 1	
EMC	CISPR 22:1993+A1+A2, Class B/ EN 55022:1994+A1+A2, Class B	
	IEC 1000-3-2:1995 / EN 61000-3-2:1995	
	IEC 1000-3-3:1994 / EN 61000-3-3:1995	
	EN 50082-1:1992	
	IEC 801-2:1991 / prEN 55024-2:1992	± 4 kV CD; ± 8 kV AD
	IEC 801-3:1984 / prEN 55024-3:1991	3 V/m
IEC 801-4:1988 / prEN 55024-4:1992	± 1.0 kV power lines	

**Supplementary information:**

The product herewith complies with the requirements of the Low Voltage Directive 73/23/EEC and the EMC Directive 89/336/EEC and carries the CE-marking accordingly.  
LEDs in this product are Class 1 in accordance to EN60825-1.

Greeley, Colorado, USA, December 1999

\_\_\_\_\_  
Jodi Schilling - Quality Manager

European Contact: Your local Hewlett-Packard Sales and Service Office or Hewlett-Packard GmbH, Department ZQ/Standards Europe, Herrenberger Straße 130, D-71034 Böblingen (Fax: +49-7031-14-3143)

## FCC Declaration of Conformity

**Manufacturer's Name:** Hewlett-Packard Company

**Manufacturer's Address:** Greeley Hardcopy Division  
700 71st Avenue  
Greeley, Colorado 80634  
USA

**Contact Person:** GHC Regulatory Manager

**Telephone:** 970-350-5600

**Product Name:** HP Digital Sender 8100C

**Model Numbers:** C7707 (may contain suffix)

**Product Options:** C7707

This equipment has been tested and found to comply with the limits for a Class B digital device, pursuant to Part 15 of the FCC rules. Operation is subject to the following two conditions: (1) This device may not cause harmful interference, and (2) This device must accept any interference received, including interference that may cause undesired operation. These limits are designed to provide reasonable protection against harmful interference in a residential installation. This equipment generates, uses, and can radiate radio frequency energy, and, if not installed and used in accordance with the instruction manual, may cause harmful interference to radio communications. However, there is no guarantee that interference will not occur in a particular installation. If this equipment does cause harmful interference to radio or television reception, which can be determined by turning the equipment off and on, the user is encouraged to try to correct the interference by one or more of the following measures:

- Reorient or relocate the receiving antenna.
- Increase separation between equipment and receiver.
- Connect equipment into an outlet on a circuit different from that to which the receiver is located.
- Consult your dealer or an experienced radio/TV technician.

Any changes or modifications to the digital sender that are not expressly approved by Hewlett-Packard could void the user's authority to operate this equipment. Only use the cables, connectors, power cords and accessories supplied with this equipment or expressly approved by Hewlett-Packard.

**Test report on file:** C7707-1

**Date:** December, 1999

## German noise declaration

### **Geräuschemission**

LpS < 70 dB

am Arbeitsplatz

normaler Betrieb

nach DIN 45635 T. 19

Die Daten sind die Ergebnisse von Typprüfungen





# Index

## Symbols

.tif format files 9  
 /d code 51  
 /dir code 51  
 /f code 51  
 /l code 51  
 /p code 51  
 /tr code 51

## Numerics

2000 warranty 65

## A

A4-sized paper 7  
 AB Error message 56  
 AC line voltage 71  
 access rights,insufficient 60  
 accessories and supplies  
   ordering 66  
   warranty 63  
 accounts,invalid credentials 58  
 acoustic emissions 71  
 Acrobat Reader,website 9  
 activity information 33  
 adding  
   addresses to distribution list 46  
   addresses to public e-mail book 47  
   HP JetSend devices 23  
   lists to address book 45  
   user profiles 42  
 address books  
   adding lists 45  
   adding to public e-mail 47  
   checking 39  
   clearing database 40, 44  
   control panel error messages 56  
   deleting lists from 45  
   descriptions 44  
   error messages 56  
   errors 57  
   failure to initialize 61  
   internal errors 61  
   maintaining 45  
 Address Caching Enabled setting 26

addresses  
   adding to distribution list 46  
   deleting from distribution list 46  
 ADF (automatic document feeder)  
   cable 14  
   cleaning 53  
   connector socket 14  
   illustration 13  
   maximum pages 7  
   paper sizes supported 7  
   specifications 72  
 adjusting  
   contrast for scanning 41  
   contrast of display 48  
 administrator  
   activities 25  
   changing password for 31  
   description 11  
   erasing password for 31  
   tools 37  
 Administrator E-mail parameter 26  
 Administrator Full Name parameter 26  
 administrator guide,part numbers 66  
 Administrator Password parameter 26  
 Adobe Acrobat Reader,website 9  
 agreements,service 69  
 Allow Guest Login parameter 26  
 America Online support service 69  
 AOL support service 69  
 assigning IP address  
   default timeout 17  
   manually 27  
 authorized dealers 69  
 Auto BCC Function Enabled parameter 29  
 automatic document feeder (ADF). *See* ADF (automatic document feeder)

## B

B/W contrast,changing 41  
 B/W Document,sending quality 8  
 backing up  
   address books 50  
   codes 51  
   device configuration 50

backup utility 50  
 Bad packets parameter 35  
 Boot Block Ver. parameter 36  
 BOOTP, using to assign IP address 17  
 Box Version # parameter 35

## C

capacity of ADF 7  
 cards, connector to network interface 14  
 changing  
   administrator password 31  
   contrast 41  
   user profiles 42  
 characters, maximum number of 74  
 checking the address book database 39  
 checklist for configuration 17  
 cleaning  
   ADF 53  
   device 52  
   scanner glass 52  
 clearing, address book database 40  
 codes  
   for backing up and restoring 51  
   internal messages 61  
 Collisions parameter 35  
 Color Document, sending quality 8  
 color, sending 8  
 Color-B/W Photo sending quality 8  
 components  
   hardware 12  
   software 24  
 compression features 71  
 configuration  
   checklist 17  
   extended and optional 16  
   minimum 16  
   parameters in configuration menu 26  
   preparing for 17  
   resetting to factory defaults 38  
   using the control panel 22  
 configuration menu, parameters 26  
 configuring  
   e-mail 16  
   e-mail parameters at control panel 20  
   extended parameters 22  
   HP JetSend devices 23  
   I-fax 16  
   I-fax parameters at control panel 21  
   optional parameters 22  
 conformity, declaration of 75  
 connector socket 14

connectors  
   control panel cable 14  
   control panel socket 14  
   illustration 14  
   power socket 14  
   print server 14  
 consumption, power 71  
 contrast  
   changing 41  
   changing display 48  
 control panel  
   assigning IP address from 17  
   changing contrast 48  
   configuring device 22  
   configuring e-mail parameters 20  
   configuring I-fax parameters 21  
   connector cable 14  
   illustration 12  
   maximum number of selections 74  
   messages 56  
   socket connector 14  
   specifications 72  
 controlling access to device 32  
 convenience copying  
   description 10  
   maximum number of printers 74  
 copies, e-mail messages 37  
 copying, convenience 10  
 creating, user profiles 42  
 customer support options worldwide 67  
 cycle, duty 71

## D

database of address books  
   checking 39  
   clearing 40  
   errors 57  
 date  
   firmware 35  
   setting for digital sender 26  
 Date parameter 26  
 dealers, authorized 69  
 declaration of conformity 75  
 decreasing, contrast 41  
 defaults  
   FROM field in e-mail messages 28  
   image quality for e-mail messages 29  
   IP address timeout 17  
   resetting to factory 38  
   SUBJECT field in e-mail messages 28

- defects
    - product 63
    - software 64
  - deleting
    - addresses from public e-mail address book 47
    - lists from address book 45
  - delivery,notification of e-mail 37
  - description,security 11
  - destinations
    - fax 10
    - from digital sender 9
  - DHCP,using to assign IP address 17
  - diagnostics,administrator tools 37
  - displaying,revision page 34
  - distribution lists
    - adding addresses 46
    - deleting addresses 46
    - maintaining 45
    - maximum number of destinations 74
  - distribution services 9
  - DNS (Domain Name System)
    - configuration problem 56
    - support 9
  - DNS Domain parameter 28
  - DNS Server Address parameter 28
  - document input tray 12
  - document lever 12
  - document output tray 12
  - documentation,part numbers 66
  - documents,sending color 8
  - dots per inch (dpi), resolution 71
  - dpi (dots per inch), resolution 71
  - drivers, printer 69
  - duty cycle 71
- E**
- e-mail
    - address book description 44
    - configuration 16
    - configuring parameters at control panel 20
    - copies of messages 37
    - dependencies 6
    - invalid credentials 58
    - maximum number of destinations 74
    - not configured 57
    - notification of delivery 37
  - e-mail addresses
    - adding to public e-mail address book 47
    - deleting from public e-mail address book 47
    - maximum number 74
  - E-mail Default From parameter 28
  - E-mail Default Subject parameter 28
  - E-mail File Format parameter 29
  - E-mail File Selection parameter 30
  - E-mail Language parameter 30
  - E-mail Quality parameter 29
  - E-mail Server Addr. parameter 28
  - e-mail server unavailable 57
  - e-mail service
    - configuration problem 57
    - description 9
  - Engine FW Ver. parameter 36
  - environmental specifications 73
  - equipment
    - components 12
    - specifications 71
  - erasing,administrator password 31
  - Error status 35
  - errors,in address book 57
  - ESMTP Function Enabled parameter 30
  - ESMTP support 9
  - Ethernet interface 71
  - extended configuration 16
  - extended parameters,configuring 22
  - Extended SMTP support 9
- F**
- factory defaults, resetting to 38
  - Fax # Prefix setting 29
  - Fax Account E-mail parameter 29
  - Fax File Format parameter 29
  - Fax numbers,maximum number of addresses 74
  - Fax Postage parameter 29
  - Fax Provider Domain parameter 29
  - fax service,description 10
  - fax,dependencies 6
  - faxing,maximum number destinations 74
  - features,compression 71
  - file formats
    - for e-mail 29
    - l-fax 29
  - firmware
    - print server version 35
    - scanner engine 36
    - upgrading device 49
    - version 35
  - Framing err. parameter 35
  - FROM field in e-mail messages 28
  - FW Date parameter 35
  - FW Ver parameter 35

**G**

G4 compression 71  
 Gateway Addr. status 35  
 gateway server, default 35  
 German noise declaration 77  
 glass  
   cleaning scanner 52  
   scanner 13  
 guest login 32  
 guest users, description 11

**H**

hardware  
   components 12  
   internal problems 61  
   repair assistance 67  
   specifications 71  
   warranty 63  
 HP authorized dealers 69  
 HP JetDirect Cfg. parameter 36  
 HP JetDirect FW Rev. parameter 35  
 HP JetDirect ID parameter 36  
 HP JetDirect Prd. # parameter 35  
 HP JetDirect printer servers  
   connector to card 14  
   firmware version installed 35  
   ID 36  
   not responding 58  
   product number installed 35  
   timeout 36  
   troubleshooting 62  
 HP JetDirect Timeout parameter 36  
 HP JetSend, configuring devices 23  
 HP Smart Compression Imaging Technology 71  
 HP Support Assistant compact disc 69  
 HP Web JetAdmin 24  
 humidity, specifications 73

**I**

ID, HP JetDirect printer server 36  
 I-fax  
   configuration problem 57  
   configuring 16  
   configuring at control panel 21  
   dependencies 6  
   fax file format 29  
   not configured 57  
   support 10  
 image processing options 71  
 image quality, default for e-mail messages 29

image, compression 71  
 inconsistent  
   DNS configuration 56  
   e-mail configuration 57  
 incorrect passwords 60  
 increasing, contrast 41  
 initializing address books, failure to 61  
 Initializing TCP/IP status 35  
 installation, testing 24  
 installing, digital sender 15  
 insufficient access rights 60  
 interface cards, troubleshooting 62  
 interface type 71  
 internal errors 58  
 internal failure 61  
 internal problems 61  
 Internet fax. *See* I-fax  
 invalid credentials 58  
 invalid passwords 58  
 IP address  
   assigning manually 27  
   default timeout 17  
   on self-test page 35  
 IP Address parameter 27, 35  
 IP Configuration parameter 27  
 IP Gateway parameter 27  
 IP Subnet Mask parameter 27

**J**

Jet Direct. *See* HP JetDirect printer server  
 JetSend. *See* HP JetSend  
 job queue, status 33  
 Job State screen 33  
 jobs  
   description of status 33  
   finding status 33  
 JPEG compression 71

**K**

keypad, specifications 72

**L**

LAN hardware address 35  
 LAN interface 71  
 Language parameter 26  
 language support options 67  
 languages, manuals in other 66  
 Late collisions parameter 35  
 LCD, changing contrast level 48

**LDAP (Lightweight Directory Access Protocol)**

- configuration problem 58
- protocol error 58
- server unavailable 59
- support 5
- LDAP Account Name parameter 29
- LDAP Password parameter 29
- LDAP Search Root parameter 29
- LDAP Server Address parameter 29
- LDAP Service Port parameter 29
- Legal-sized paper 7
- Letter-sized paper 7
- levers
  - document 12
  - locking 14
- light source for scanning 71
- line voltage 71
- locking lever 14
- Log Server Addr. parameter 36

**M**

- MAC address parameter 35
- Mail Ping Frequency parameter 30
- maintaining
  - device 52
  - user profiles 42
- manuals
  - in other languages 66
  - part numbers 66
- Max User Mail Size parameter 30
- maximum paper size, in ADF 7
- media. *See index entry for specific type of media*
- memory, capabilities 74
- messages
  - control panel 56
  - internal error 61
  - network error 59
- MIME support 9
- minimum
  - configuration 16
  - paper size in ADF 7
- modes, sending 8
- modifying, user profiles 42
- Multi-Boot Ver. parameter 36

**N**

- network
  - collisions 35
  - connector to interface card 14
  - error codes 59
  - errors on job state screen 33
  - framing errors 35
  - operating systems supported 6
  - packets 35
  - problems connecting to 62
  - server type 6
  - supported protocols 6
  - troubleshooting interface card 62
- no matches found message 59
- noise
  - German declaration 77
  - levels 71
- notification, e-mail delivery 37
- numbers, product and part 66
- NW Error status 33

**O**

- object not found message 59
- online support services 69
- operating
  - humidity specification 73
  - temperature 73
- operating systems, supported networks 6
- optical resolution 71
- optional configuration 16
- optional parameters, configuring 22
- overview, digital sender 5

**P**

- packets, network 35
- pages
  - capacity of ADF 7
  - displaying Revision 34
  - displaying Tasks 36
  - Revision 55
- pages per minute, scanning speed 71
- paper
  - maximum in ADF 7
  - sizes supported 7
  - specifications 7
  - weights supported 7
- Paper Size parameter 26

- parameters
    - configuration menu 26
    - configuring e-mail at control panel 20
    - configuring extended and optional 22
    - configuring I-fax 21
  - part numbers 66
  - partial results message 59
  - parts, of product 12
  - passwords
    - changing administrator 31
    - description 11
    - do not match 59
    - erasing administrator 31
    - incorrect 60
    - invalid 58
    - LDAP (control panel) 29
  - performance
    - paper handling 7
    - scanning speed 71
  - permissions, using device 32
  - Personal E-Mail address books
    - description 44
    - maximum destinations in a list 74
    - maximum number of addresses 74
    - maximum number of lists 74
  - photographs, sending 8
  - post-processing error status 33
  - power connector socket 14
  - power switch 14
  - power, consumption 71
  - PP Error status 33
  - ppm, scanning speed 71
  - print server, connector to card 14
  - printers
    - drivers 69
    - maximum number for convenience copying 74
    - sending to 10
  - printing, dependencies 6
  - Processing status 33
  - product version 35
  - profiles, creating and maintaining user 42
  - programs, installed for digital sender 24
  - protocols
    - dependency on 6
    - supported 6
    - used for e-mail 9
  - Public E-Mail address book
    - adding addresses 47
    - deleting addresses 47
    - description 44
    - maintaining 47
    - maximum number of addresses 74
    - maximum number of lists 74
  - public lists
    - adding lists 45
    - deleting lists from 45
    - maintaining 45
  - Public Printers address book, maximum number of printers 74
- ## Q
- quality
    - B/W Document 8
    - Color Document 8
    - Color-B/W Photo 8
  - quality modes 8
  - queue, jobs in 33
- ## R
- Reader, website 9
  - Ready status 35
  - receipts, e-mail delivery 37
  - Received pkts parameter 35
  - registered users
    - deleting 43
    - description 11
  - repair and replacement 63
  - repair assistance 67
  - replacement and repair 63
  - replacement parts 66
  - resetting, factory defaults 38
  - resolution, optical 71
  - restarting the digital sender 37
  - restore utility 50
  - restoring
    - address books 50
    - codes 51
    - device configuration 50
  - Revision page
    - displaying 34
    - troubleshooting with 55
  - Running Image # parameter 36

**S**

- scanner
    - specifications 72
    - type of 71
  - scanner glass
    - cleaning 52
    - illustration 13
  - scanning
    - changing contrast 41
    - setting size of area 26
    - speed 71
  - scanning element 71
  - search error message 60
  - security
    - controlling access 32
    - description 11
  - sending modes 8
  - Sending status 33
  - sending, to e-mail 9
  - Sent status 33
  - servers
    - dependencies on 6
    - e-mail unavailable 57
    - LDAP unavailable 59
    - log 36
  - service agreements 69
  - service and support
    - language options 67
    - options worldwide 67
  - settings
    - Color Document 8
    - Color-B/W Photo 8
    - time on digital sender 26
  - setup, digital sender 15
  - shutting down the digital sender 37
  - sizes
    - setting for scanning area 26
    - supported paper 7
  - Smart Compression Imaging Technology 71
  - SMTP protocol, sending to e-mail 9
  - sockets
    - connectors 14
    - control panel cable 14
    - power connector 14
  - software
    - components 24
    - compression 71
    - internal problems 61
    - utilities 69
    - warranty 63
  - specifications
    - environmental 73
    - equipment 71
    - keypad 72
    - paper handling 7
  - speed, scanning 71
  - starting the digital sender 37
  - status
    - device 33
    - job 33
  - stopping the digital sender 37
  - storage
    - humidity specification 73
    - temperature 73
  - SUBJECT field in e-mail messages 28
  - subnet mask
    - for IP address 27
    - on self-test page 35
    - parameter 35
  - supplies and accessories
    - ordering 66
    - warranty 63
  - support agreements 69
  - support and service
    - language options 67
    - options worldwide 67
  - Support Assistant compact disc 69
  - supported
    - .tif files 9
    - fax services 10
    - paper sizes 7
  - switches, power 14
- 
- T**
  - Tasks page, displaying 36
  - TCP/IP
    - configuration 36
    - dependency on 6
    - status parameter 35
  - telephone numbers, maximum number of characters 74
  - temperature
    - operating 73
    - storage 73
  - testing, installation 24
  - Time parameter 26
  - timeout
    - default IP address 17
    - HP JetDirect printer server 36
  - Token Ring interface 71

- tools
  - for administrator 37
  - troubleshooting 51, 55
- Transm. pkts. parameter 35
- transmission packets 35
- trays
  - document input 12
  - document output 12
- troubleshooting
  - administrator tools 37
  - cleaning device 52
  - DNS configuration 56
  - e-mail configuration 57
  - errors in address books 57
  - HP JetDirect printer servers 62
  - I-fax configuration 57
  - information on 55
  - internal errors 58, 61
  - LDAP configuration 58
  - network errors 59
  - network interface card 62
  - repair assistance 67
  - Revision page 55
  - sources for information 51
  - testing installation 24
  - tools 55
  - WINS configuration 60
- types of users 11

**U**

- upgrading, device firmware 49
- user guide, part numbers 66
- User Self-registration Enabled setting 27
- user's e-mail addresses
  - description 44
- user's e-mail lists, description 44
- users
  - creating and maintaining profiles 42
  - deleting profiles 43
  - maximum number 74
  - name not found 60
  - not registered 60
  - types 11
- utilities, software 69

**V**

- versions
  - boot block 36
  - firmware 35
  - multi-boot program 36
  - print server firmware 35
  - product 35
  - scanner firmware 36
- voltage, AC line 71

**W**

- warranty
  - hardware 63
  - software 63
  - year 2000 65
- watts consumed 71
- Web JetAdmin. *See* HP Web JetAdmin
- websites
  - Adobe Systems Incorporated 9
  - firmware upgrade 49
- weight
  - digital sender 71
  - paper 7
- WINS (Windows Internet Naming Service), configuration problem 60
- WINS Server Address parameter 28
- World Wide Web support service 69
- worldwide, support options 67
- WWW support service 69

**Y**

- Y2K warranty 65
- year 2000 warranty 65





